

### LEGEND

**ROADS AND ROADWAY FEATURES**

- UNIMPROVED ROAD
- GRAVEL
- PAVED ROAD
- UNPAVED HIGHWAY
- DIVERSIFIED HIGHWAY
- INTERSTATE SYSTEM
- CITY STREETS

**NAVIGATION**

- DOCK, PIER, OR LANDING
- LEVEL OR DIKE WITH ROAD
- LEVEL OR DIKE WITH ROAD

**CITY AND VILLAGE CENTERS**

- COUNTY SEAT
- OTHER CITIES AND VILLAGES

**HIGHWAY BRIDGES**

- BRIDGE 50 FEET AND OVER
- DRAWBRIDGE
- RAILROAD CROSSING
- HIGHWAY GRADE SEPARATION
- HIGHWAY INTERCHANGE

**ROAD SYSTEM DESIGNATION**

- INTERSTATE NUMBERED
- U.S. NUMBERED
- STATE NUMBERED

**RAILROADS**

- RAILROAD STATION
- GRADE CROSSING
- RAILROAD ABOVE
- RAILROAD BELOW
- GRAVEL PIT

**AIRPORTS**

- MILITARY AIRPORT
- AIRPORT LIMITED FACILITIES
- LANDING AREA ON STRIP (INCLUDING PRIVATE AIR FIELDS)
- AIRPORT COMPLETE FACILITIES
- AIRWAY LIGHT BEACON

**BOUNDARIES**

- STATE BOUNDARY
- COUNTY BOUNDARY
- BEAT LINE
- CONGRESSIONAL TOWNSHIP
- SECTION LINE
- NATIONAL OR STATE FOREST
- RESERVATION, PARKS ETC.
- URBAN AREA CONTRACT
- INCORPORATED DELIMITED AREAS

**MISCELLANEOUS**

- TRANSLOCATION STATION
- BENCH MARK WITH ELEVATION

**PUBLIC SERVICE FACILITIES**

- OBSERVATION OR LOOKOUT TOWER
- HIGHWAY GARAGE
- POST OFFICE
- POWER PLANT
- WRESTLING STATION
- HOSPITAL
- SEWAGE DISPOSAL PLANT
- COMMUNITY CENTER OR TOWNHALL
- NATIONAL PARK GARAGE
- PUBLIC LIBRARY
- SANITARY LAND FILL
- CORRECTIONAL INSTITUTION
- POLICE STATION
- GRAVEL PIT

**CONSERVATION AND RECREATION**

- MOTEL OR HOTEL
- CAMP OR LODGE
- HISTORIC OR SCENIC SITE
- FAIR GROUNDS OR RACE COURSE
- SMALL PARK
- COLF COURSE OR COUNTRY CLUB

**INDUSTRIAL**

- FACTORY OR INDUSTRIAL SECTOR
- SEASONAL INDUSTRY

**CHURCHES AND CEMETERIES**

- CHURCH
- CEMETERY
- CHURCH WITH CEMETERY ADJACENT

**EDUCATION**

- SCHOOL

**MISCELLANEOUS STRUCTURES**

- ARMORY
- FORT
- ARMY CAMP

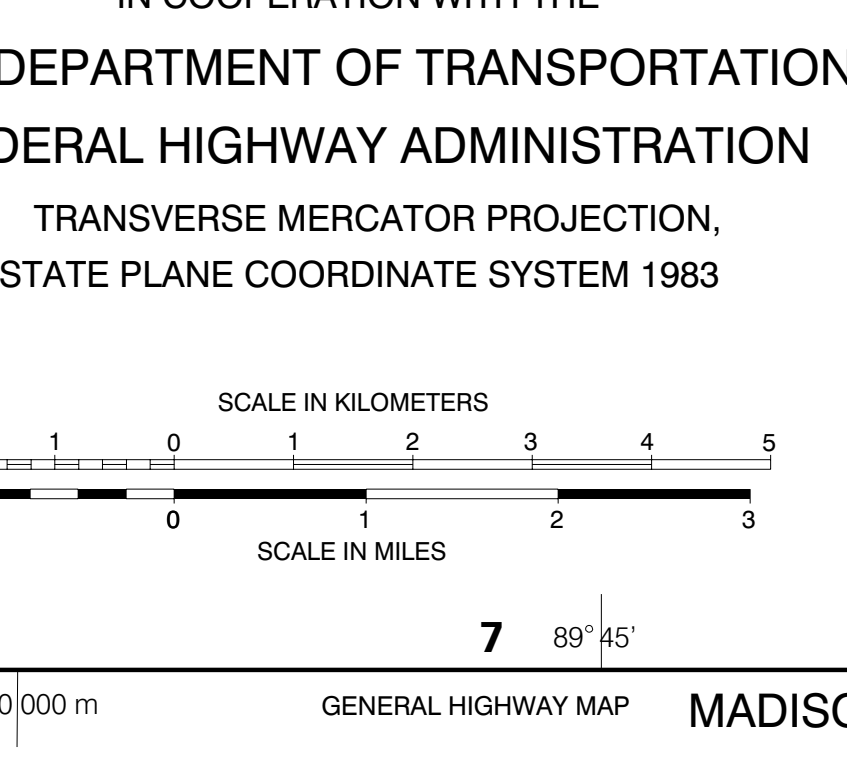
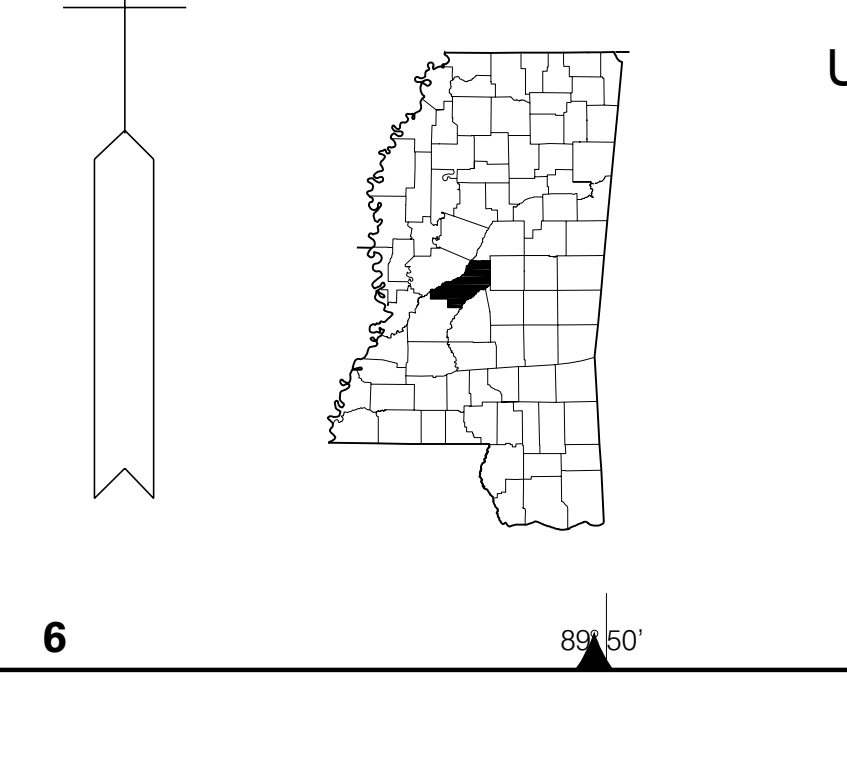
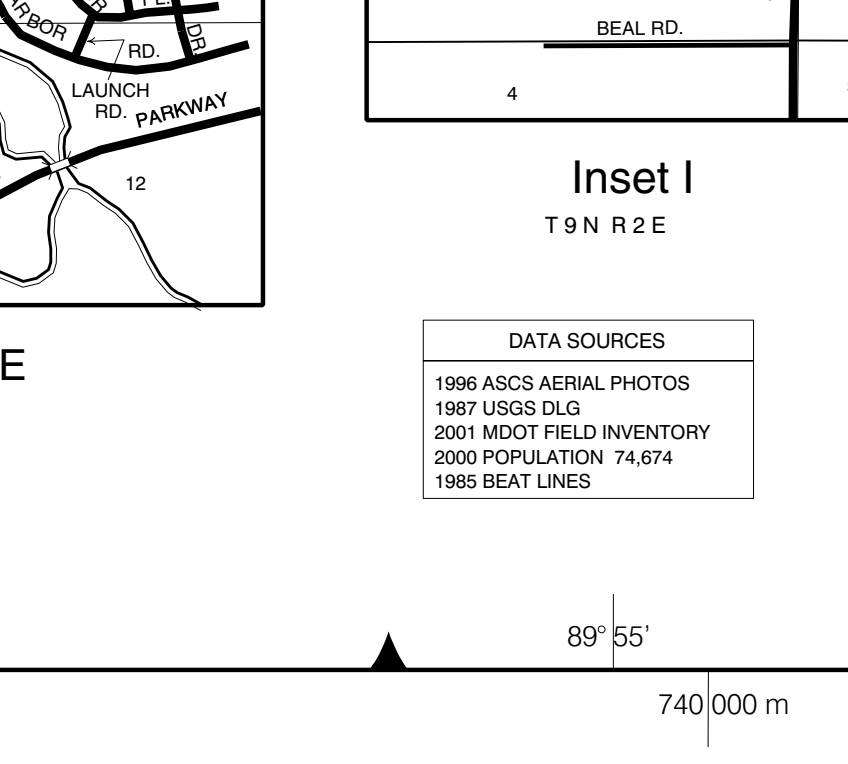
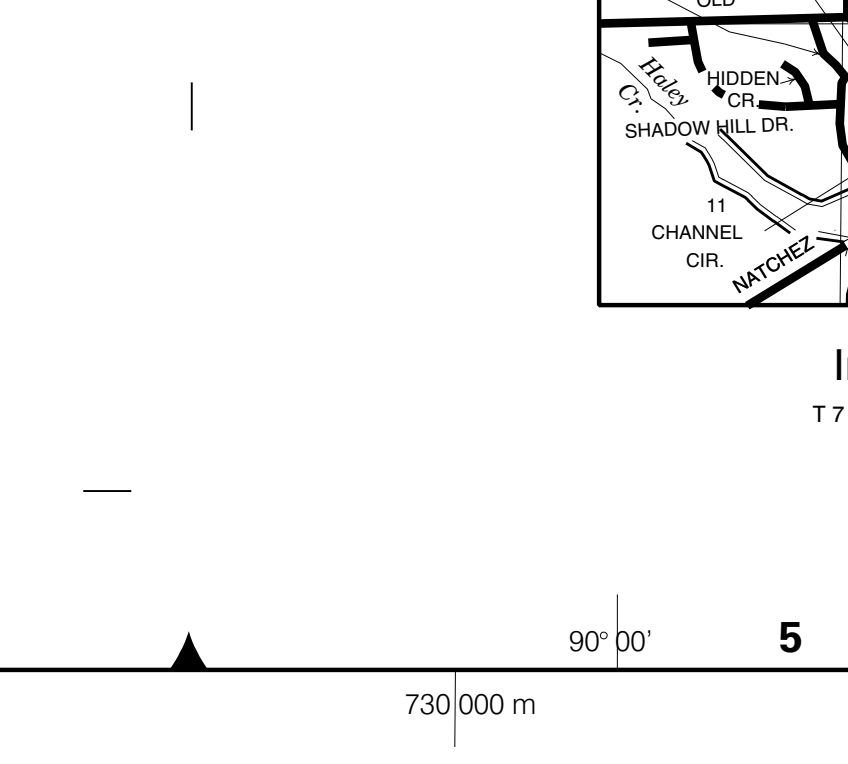
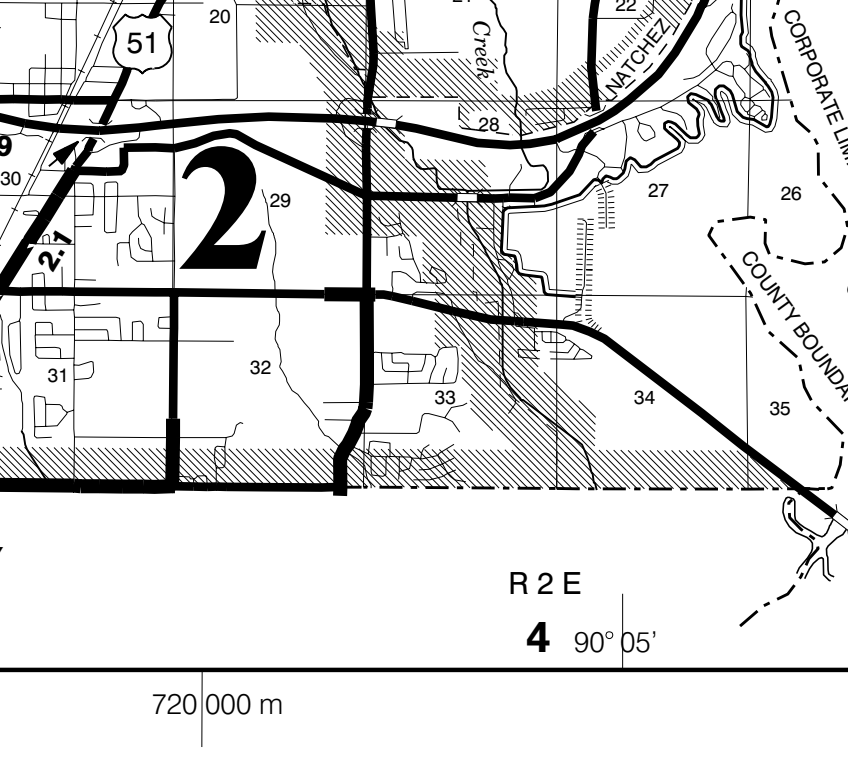
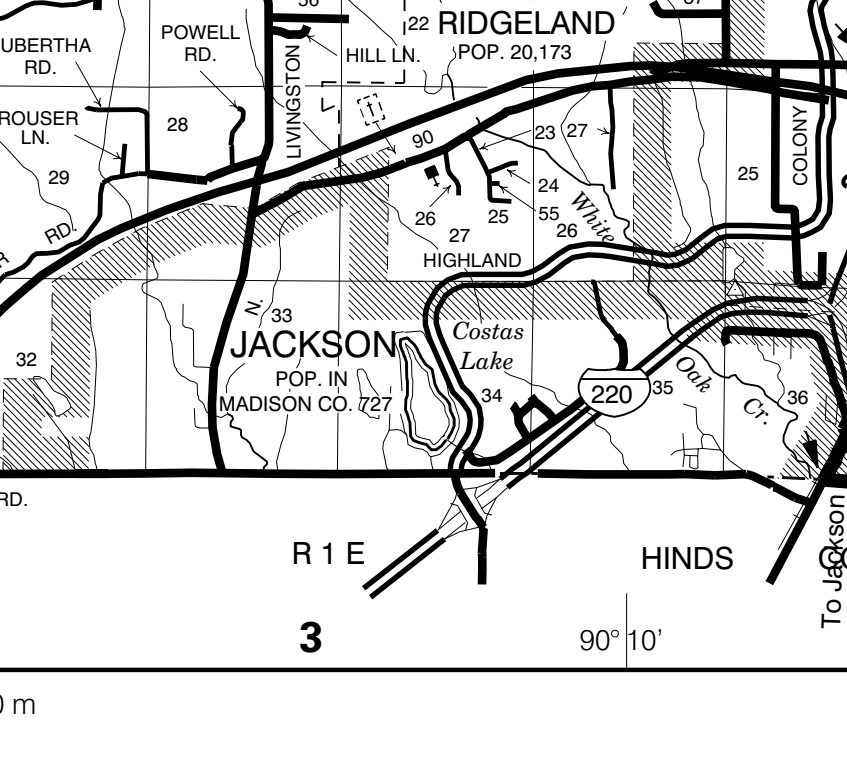
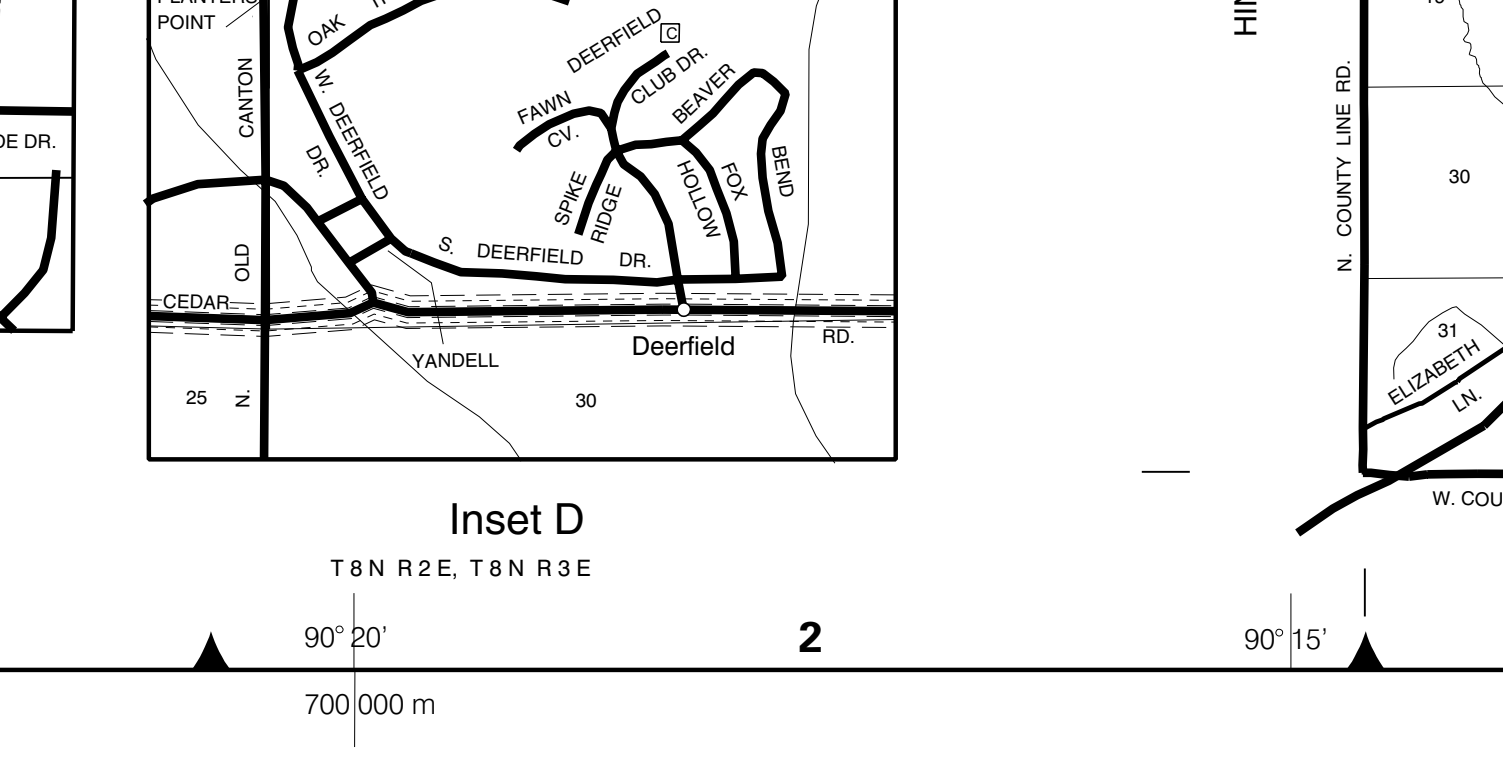
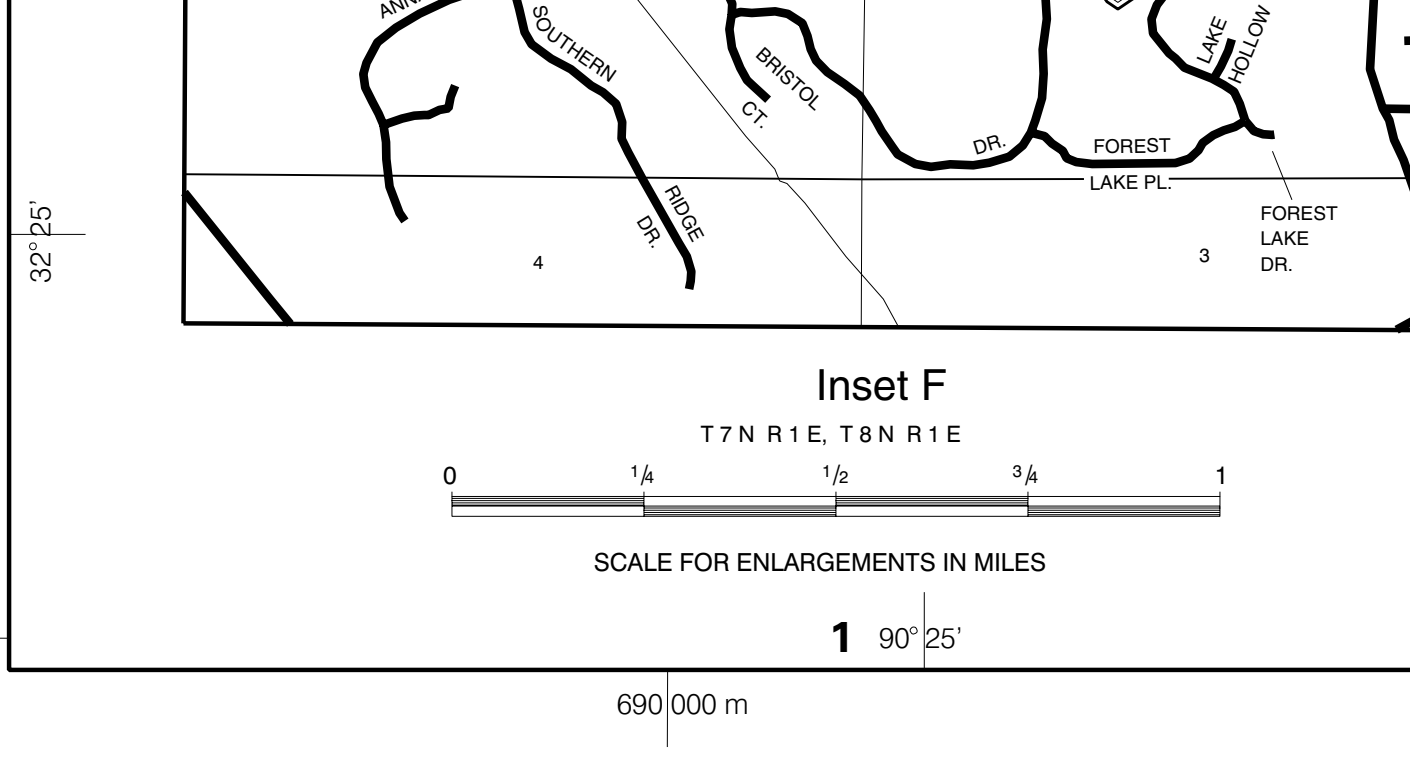
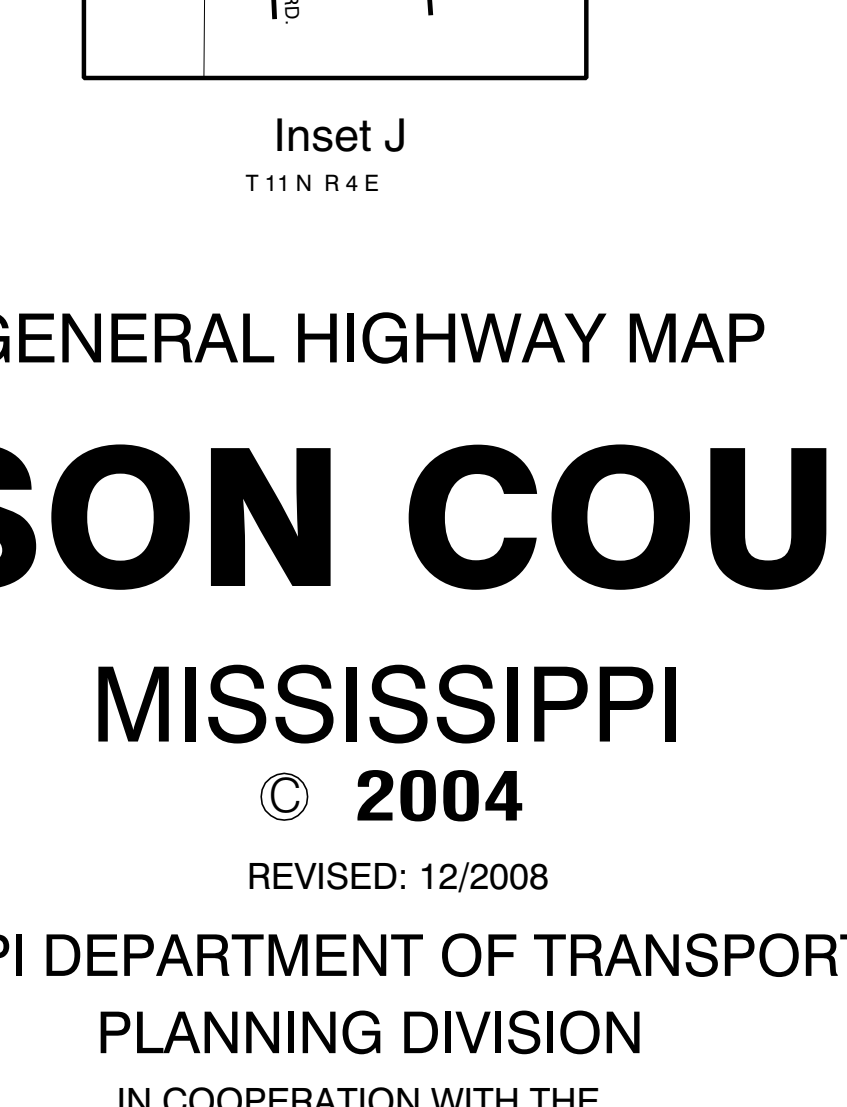
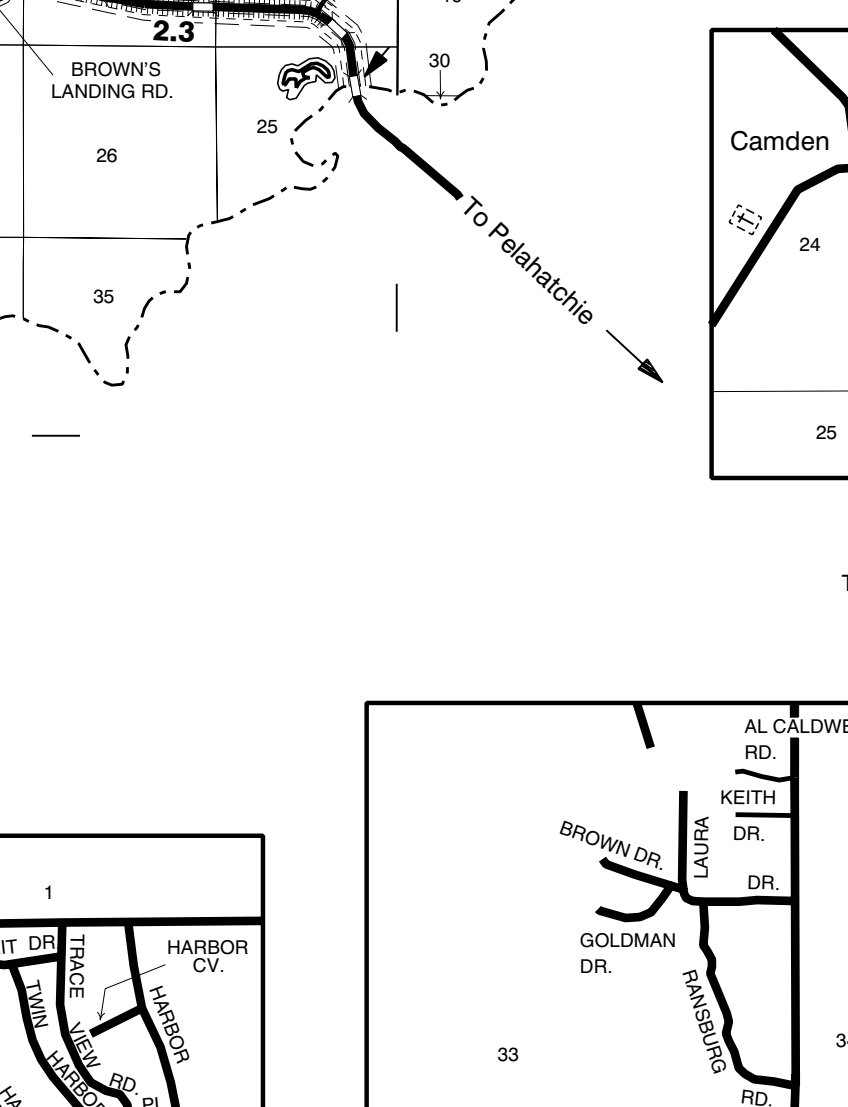
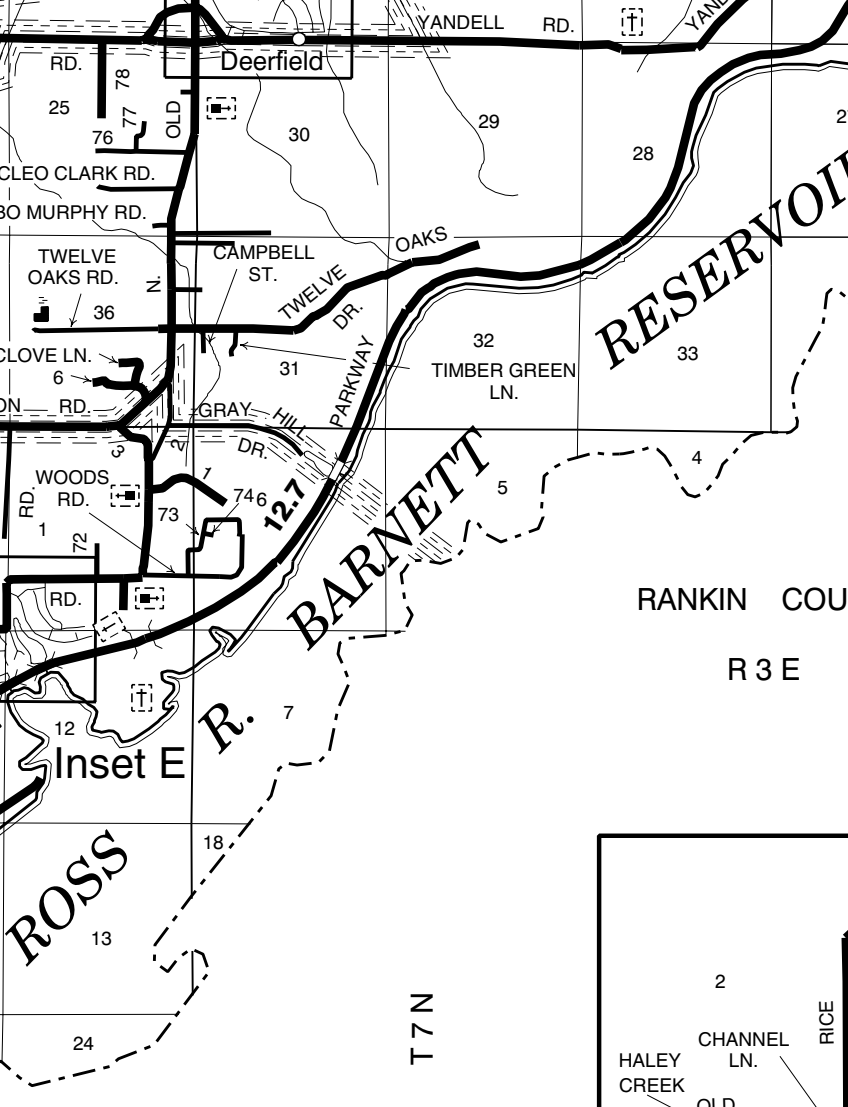
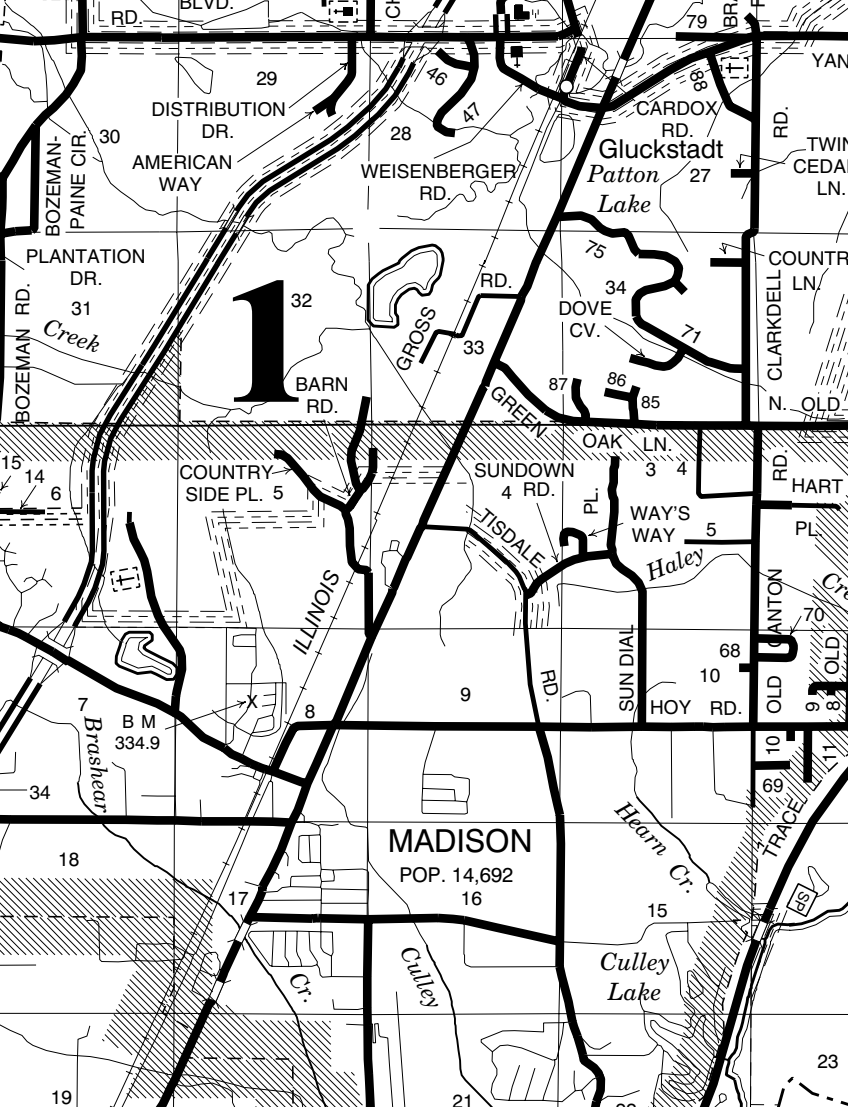
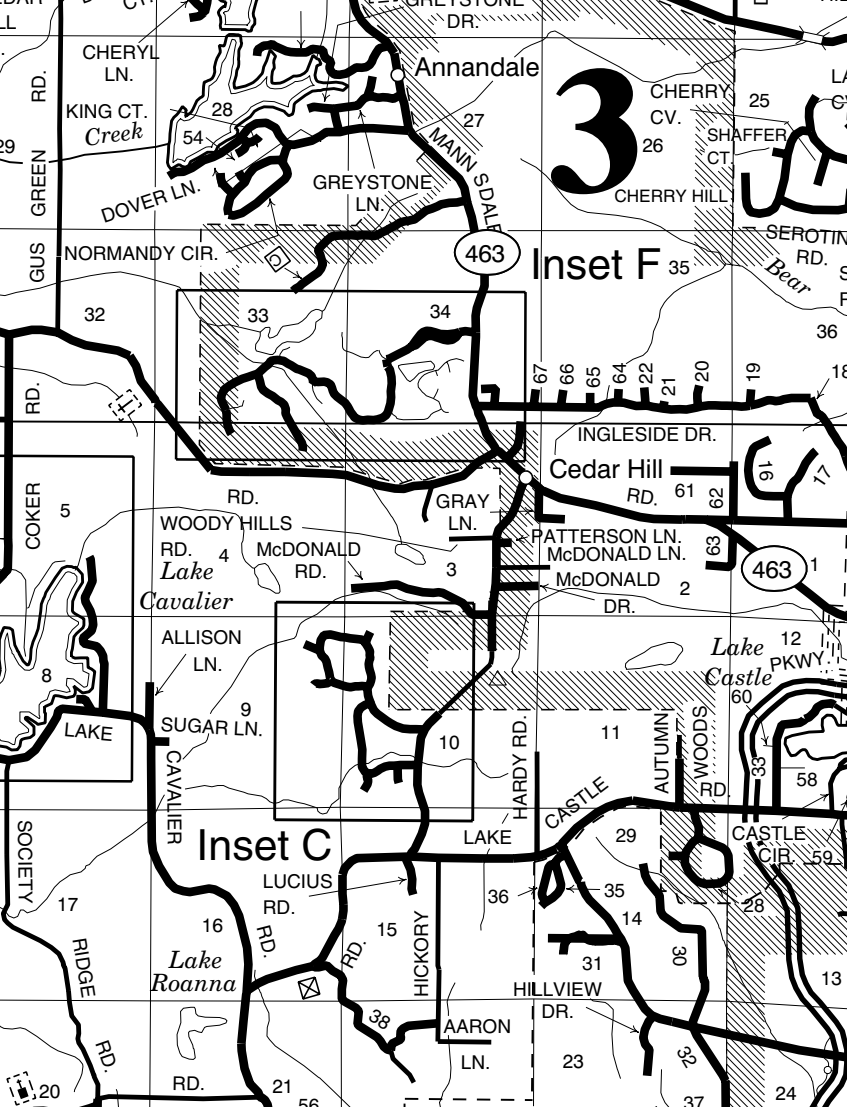
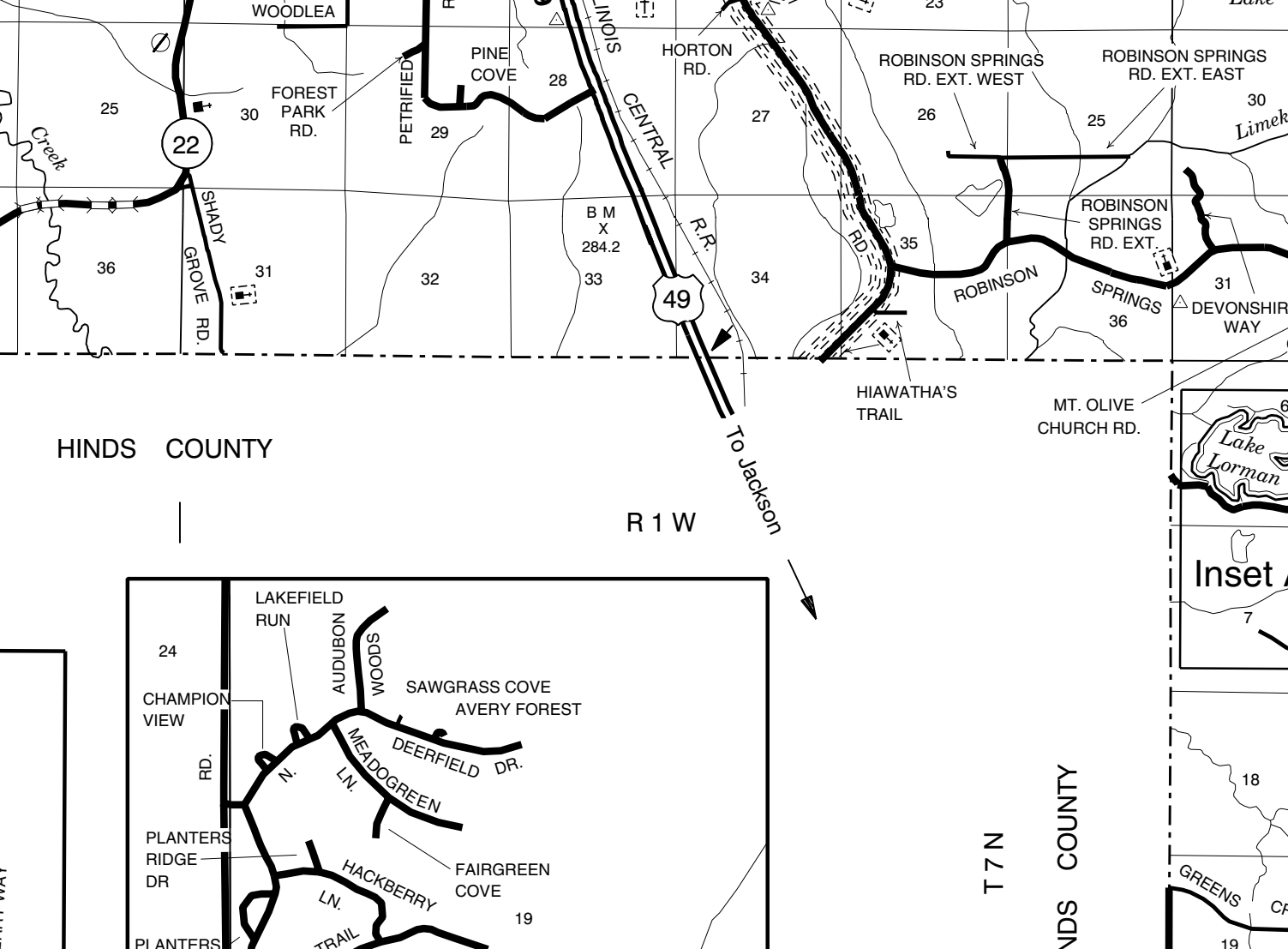
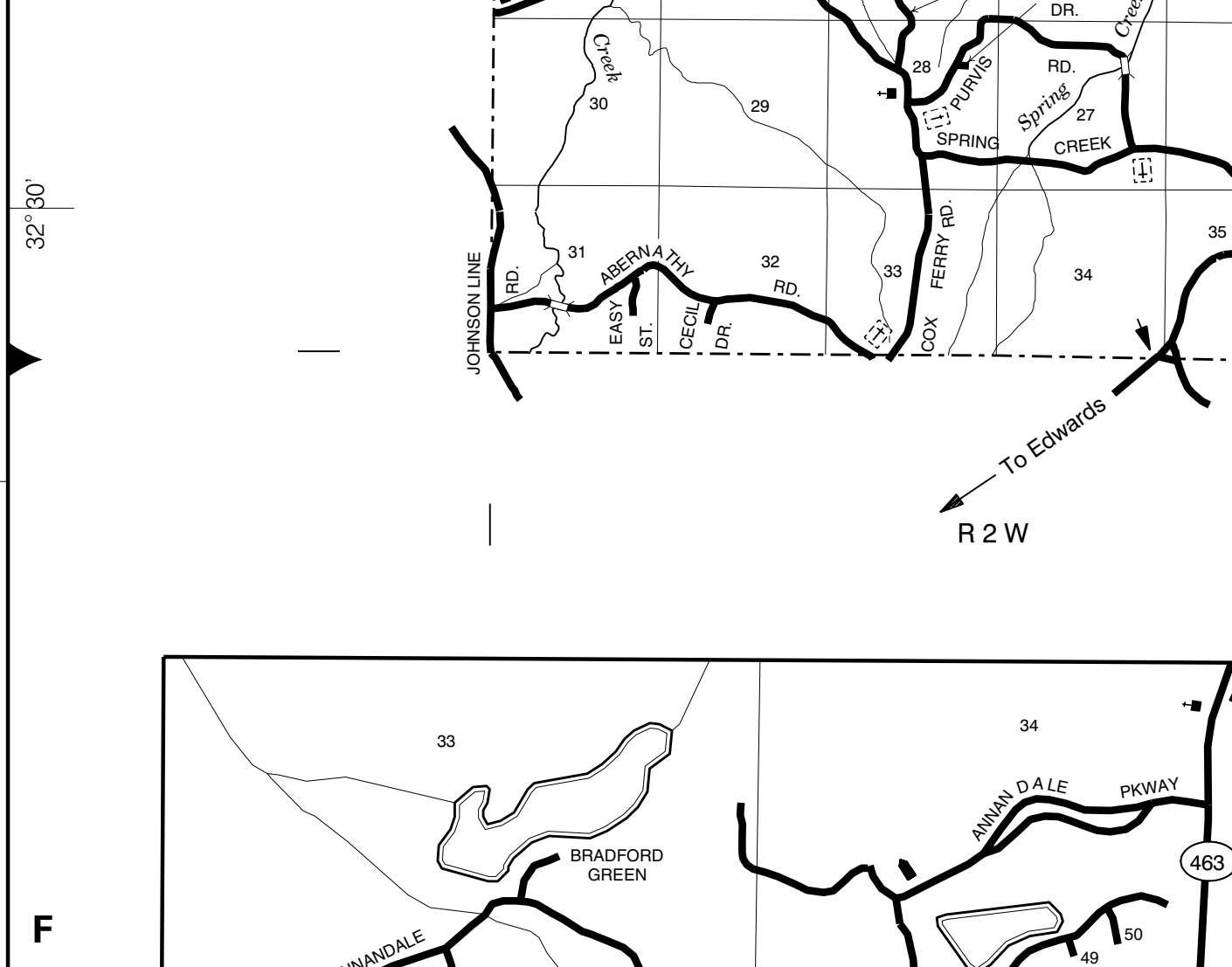
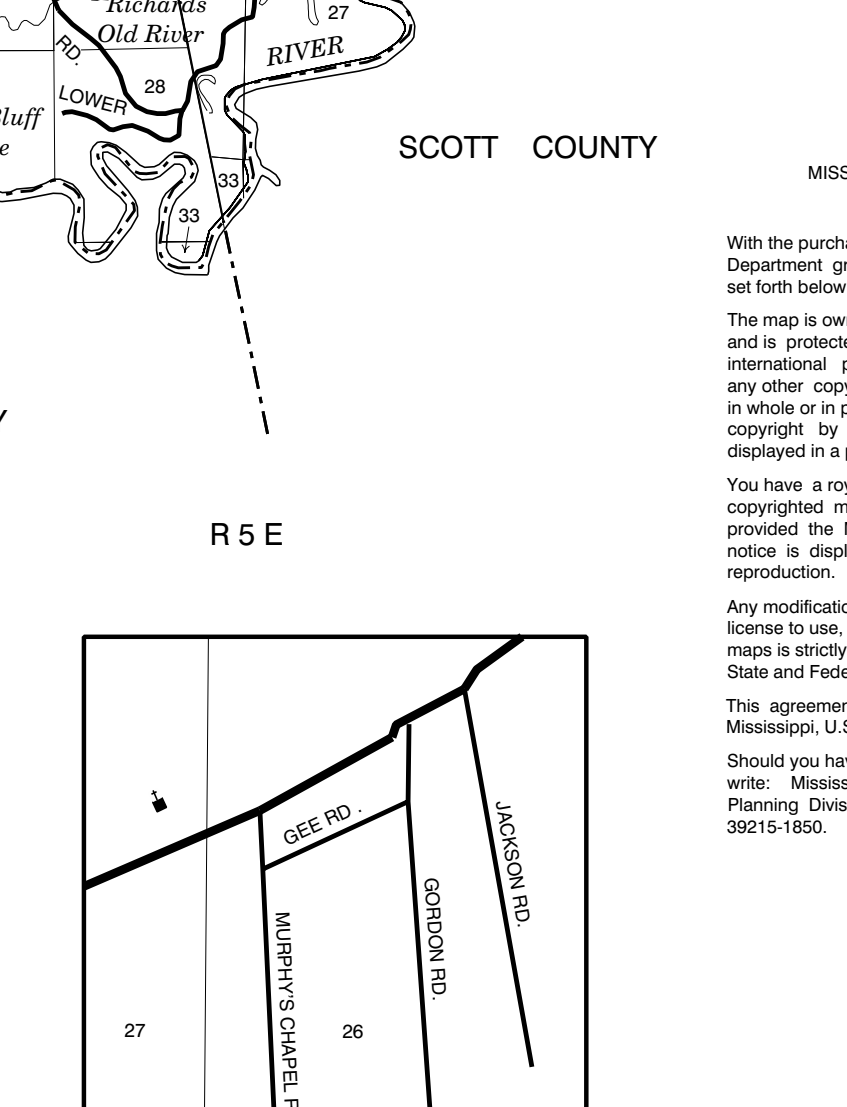
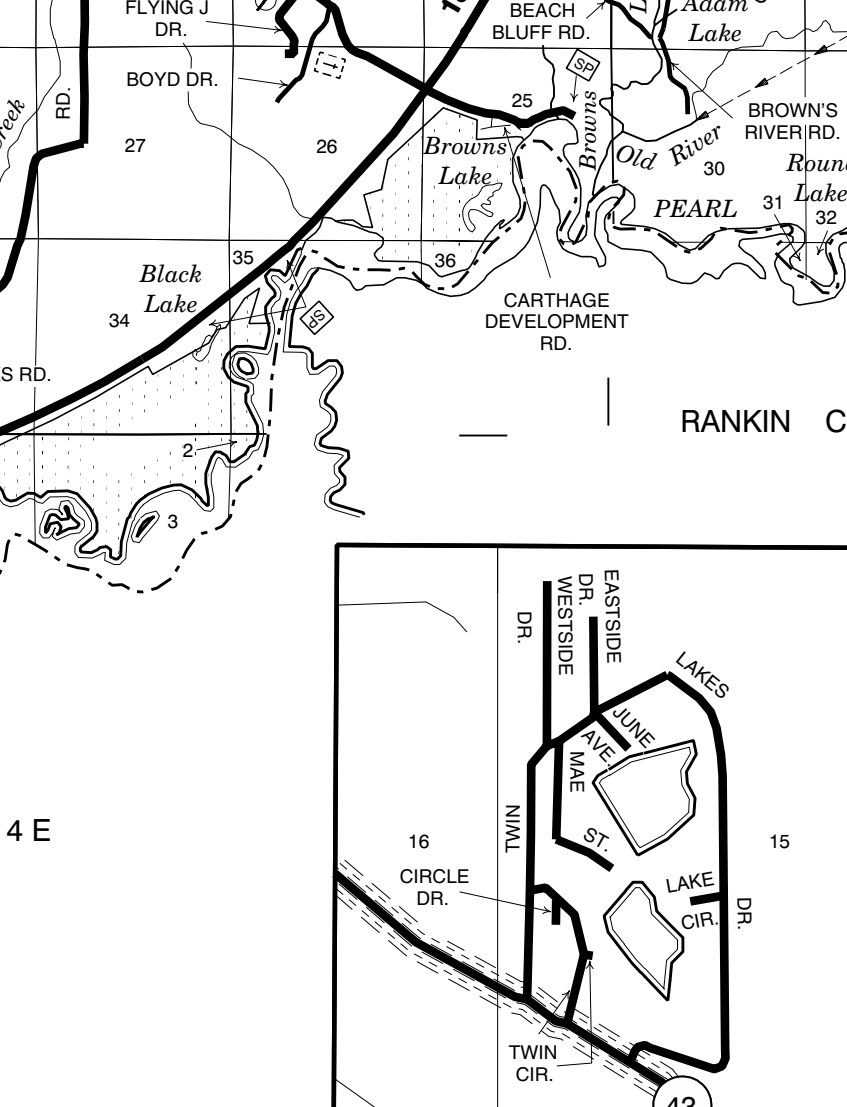
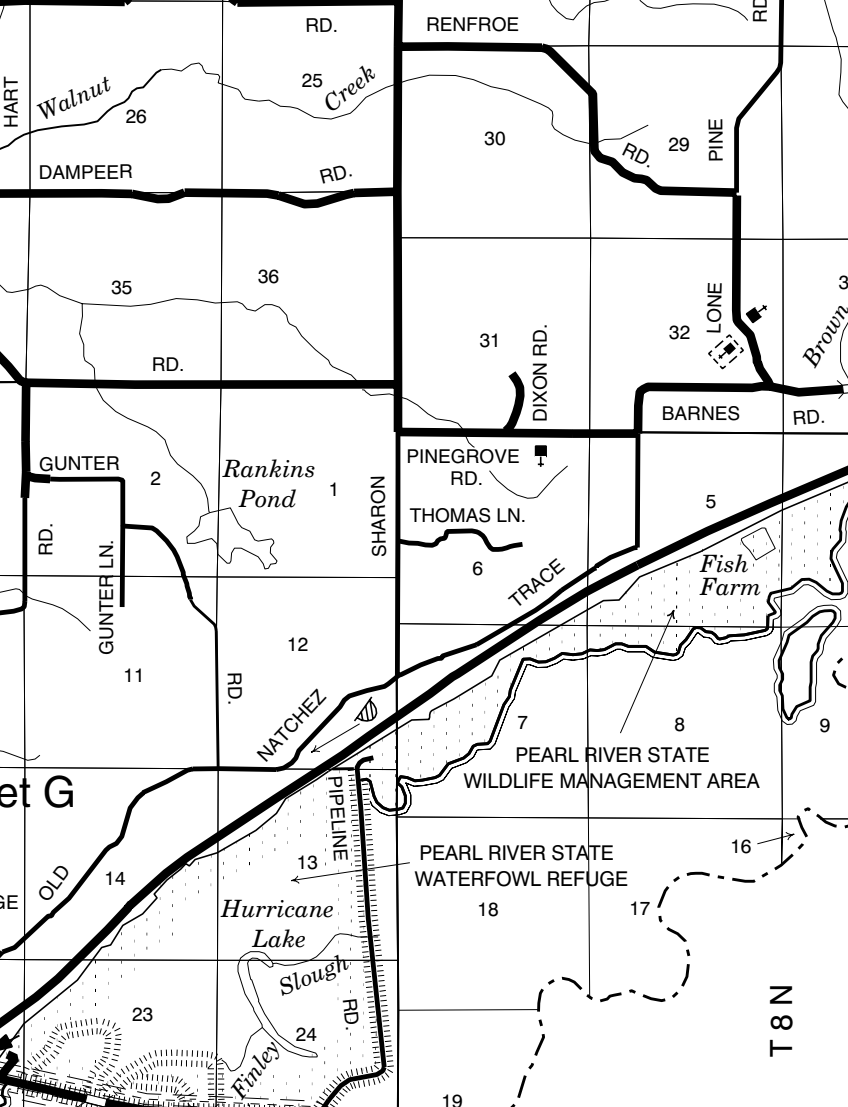
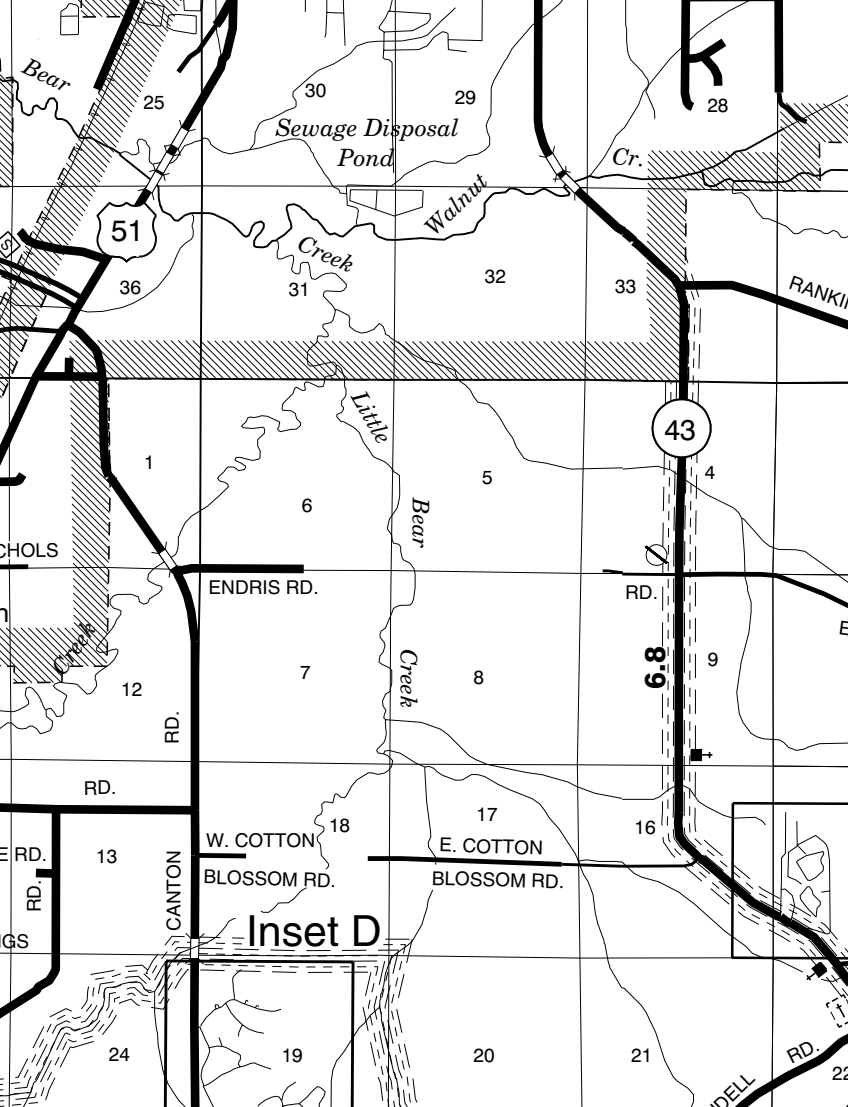
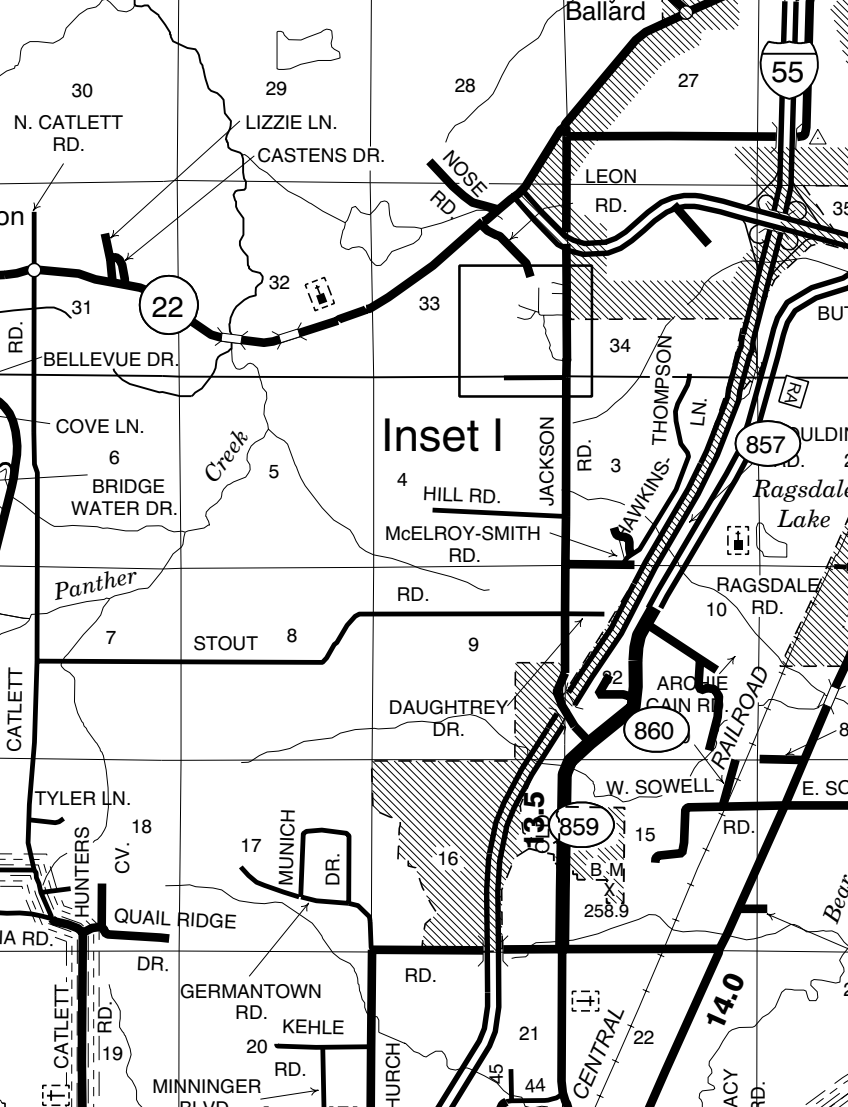
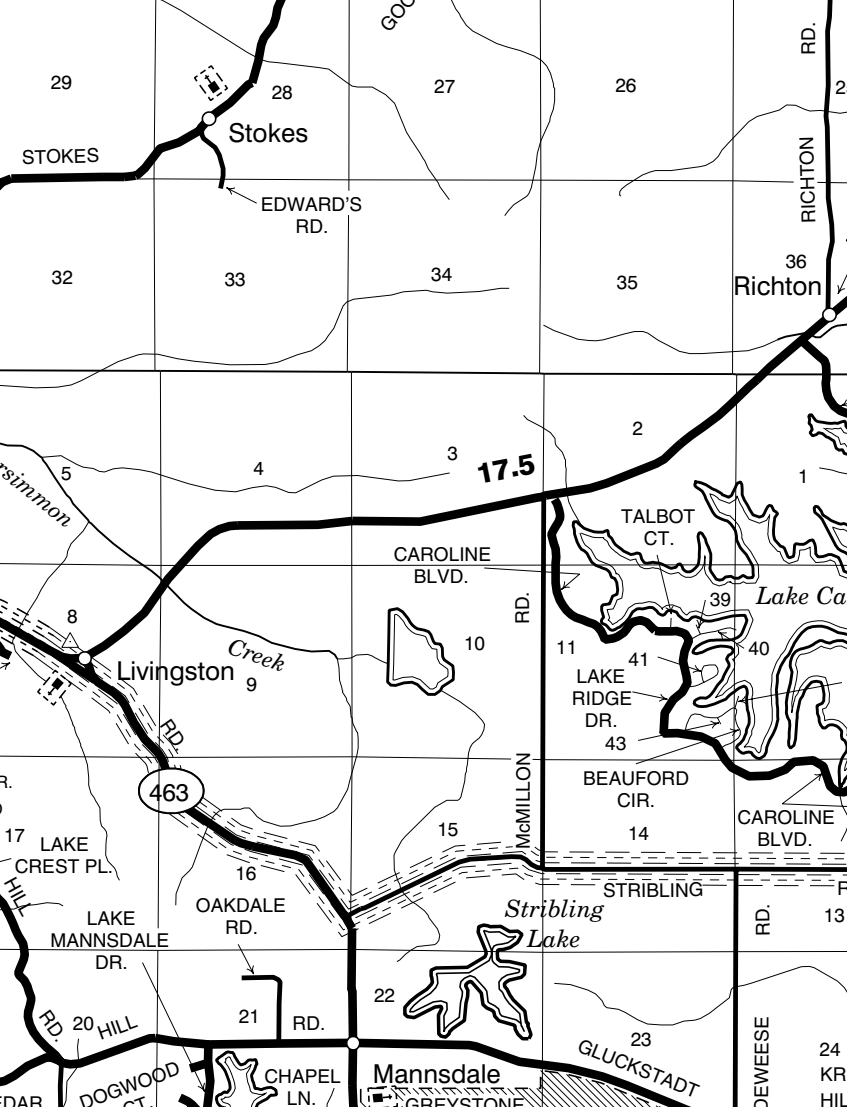
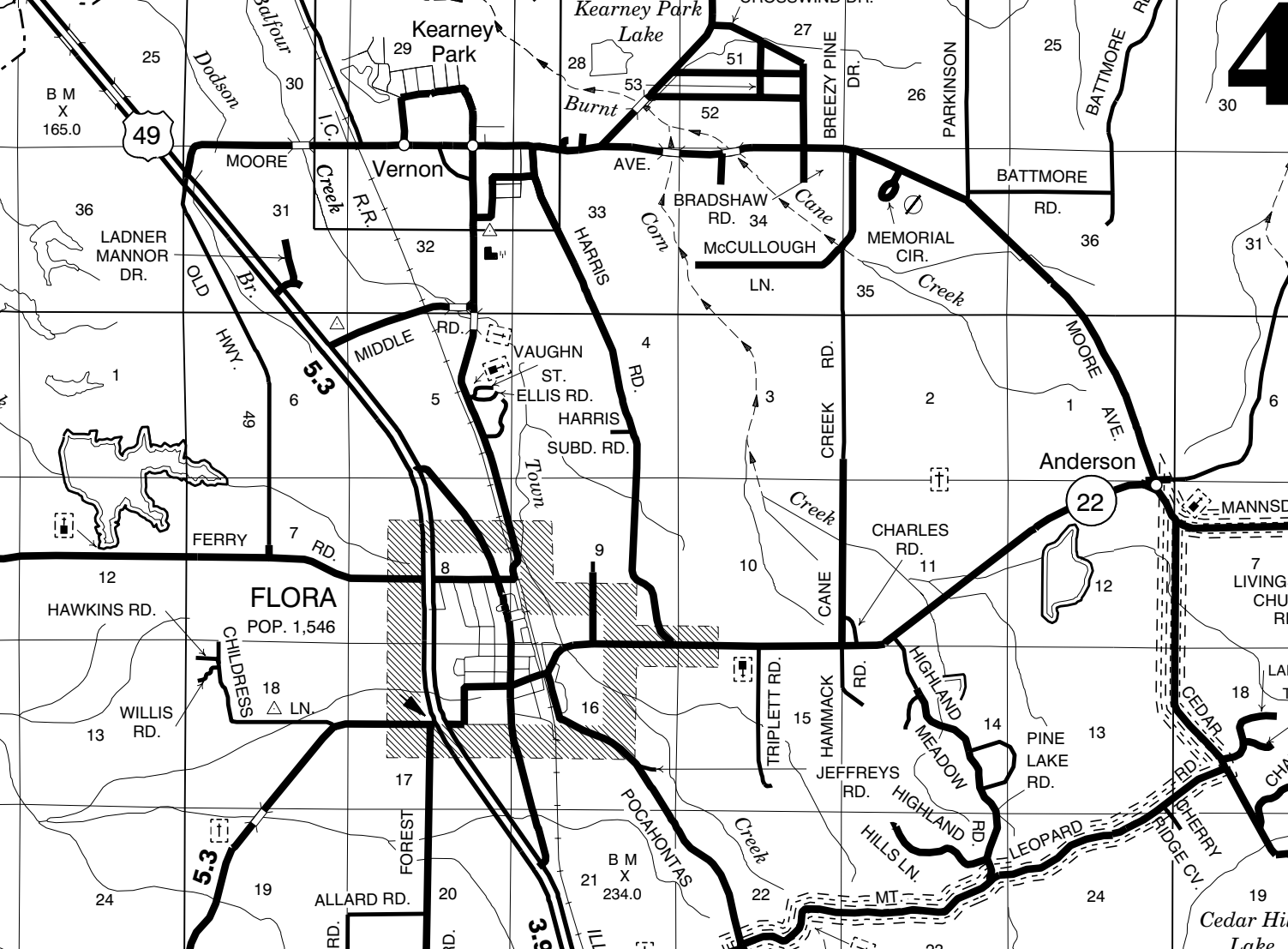
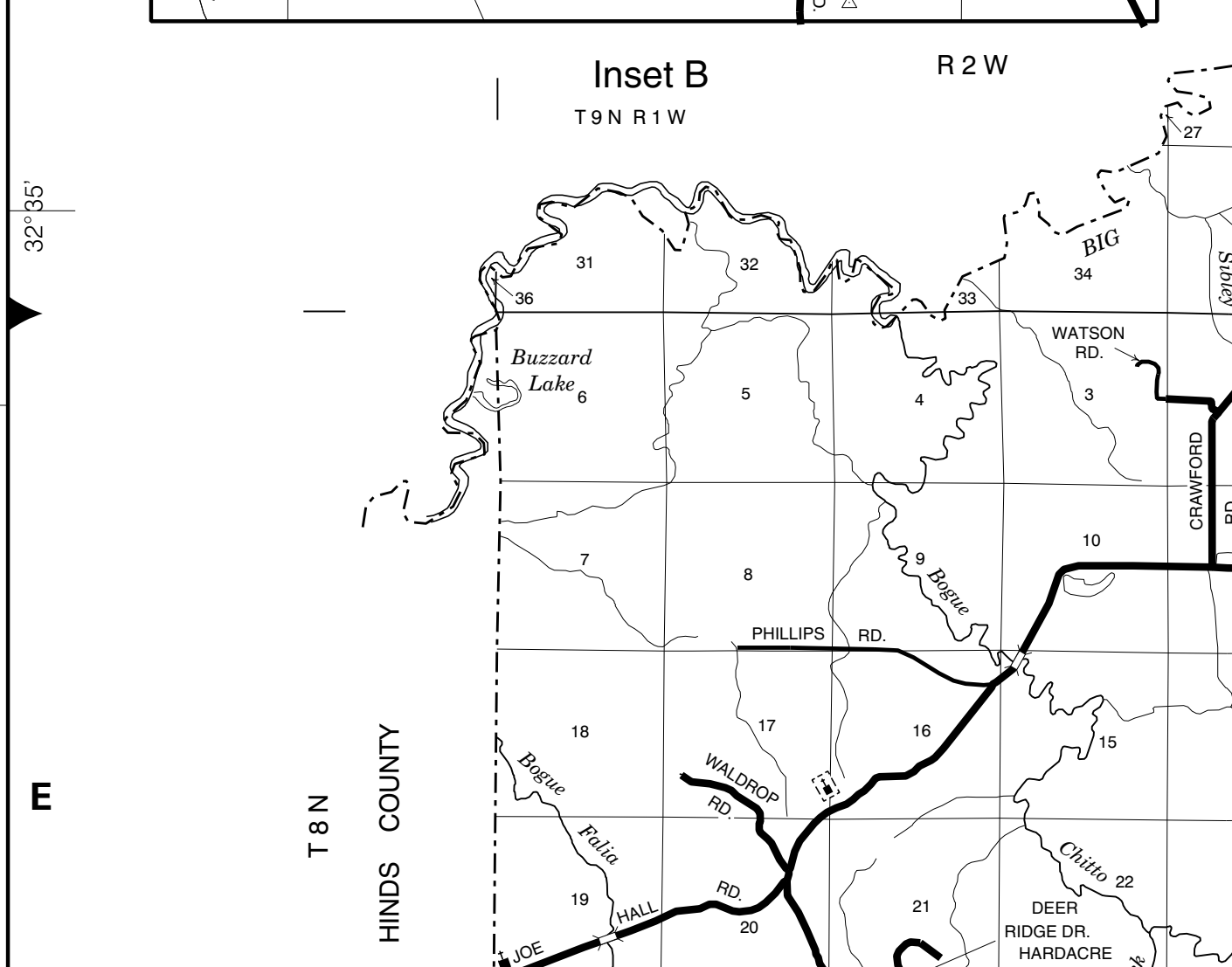
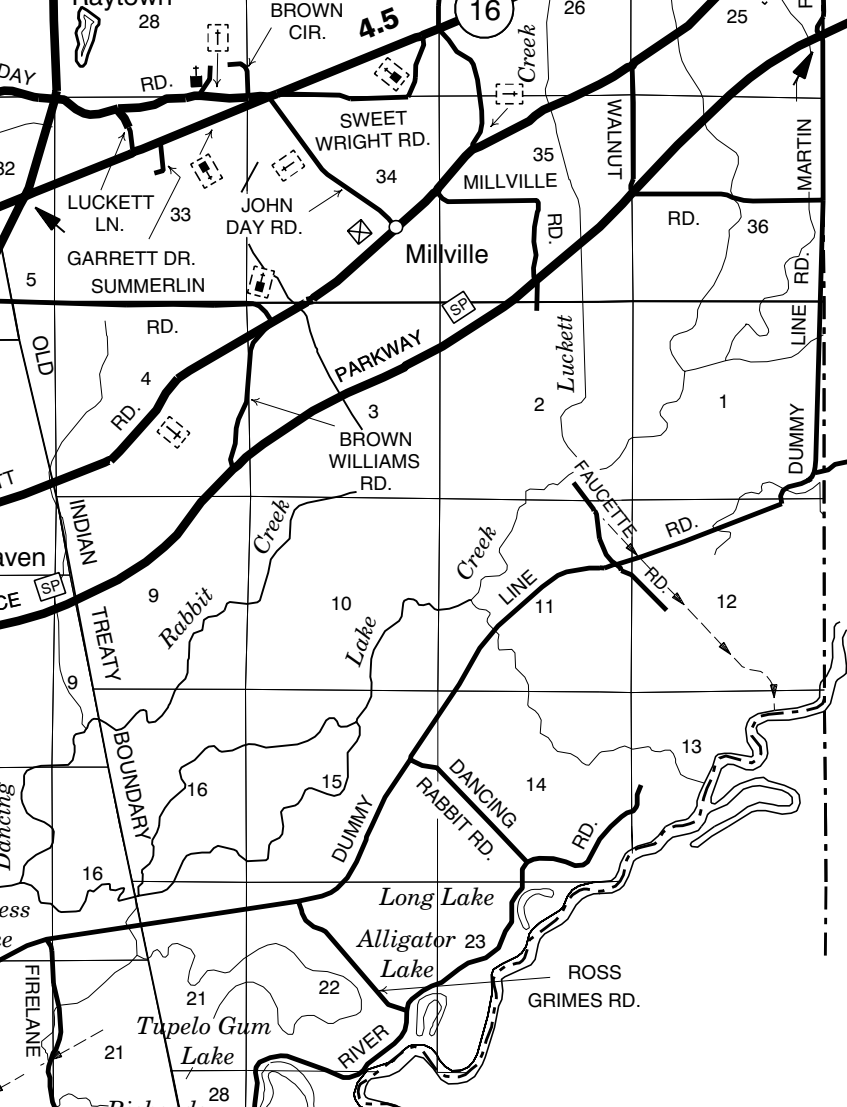
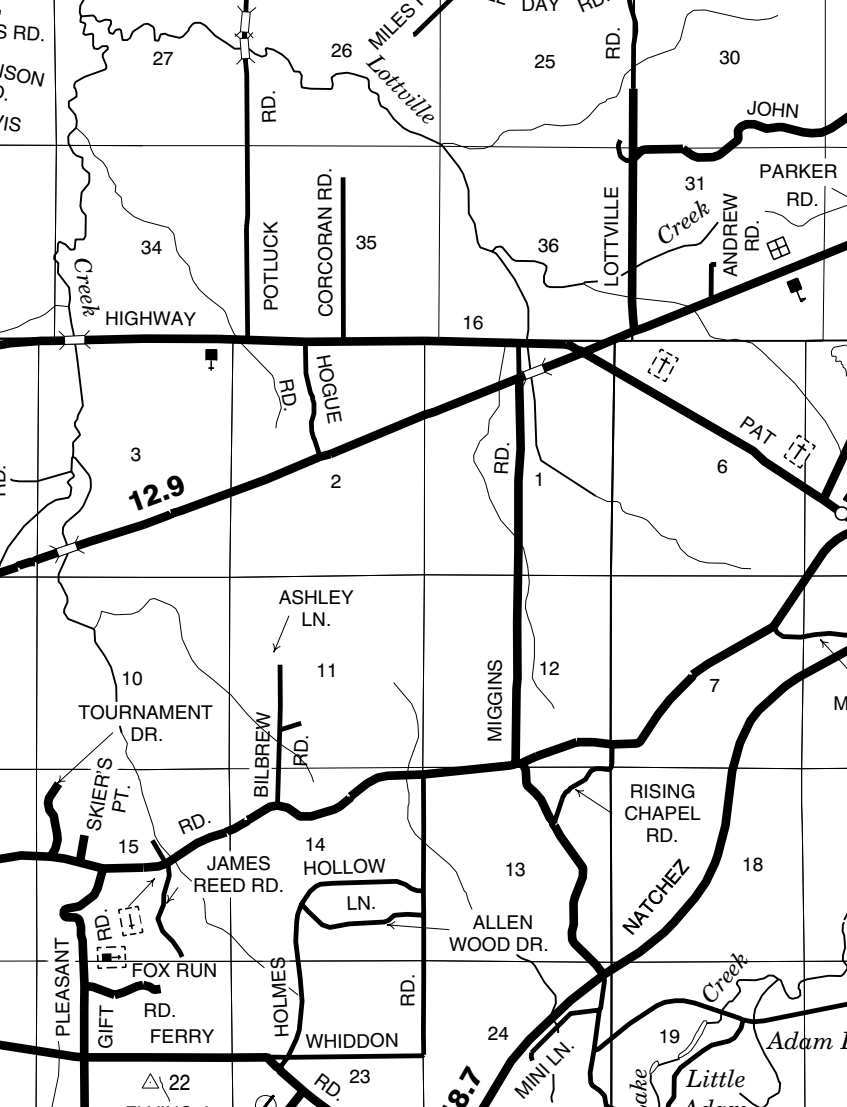
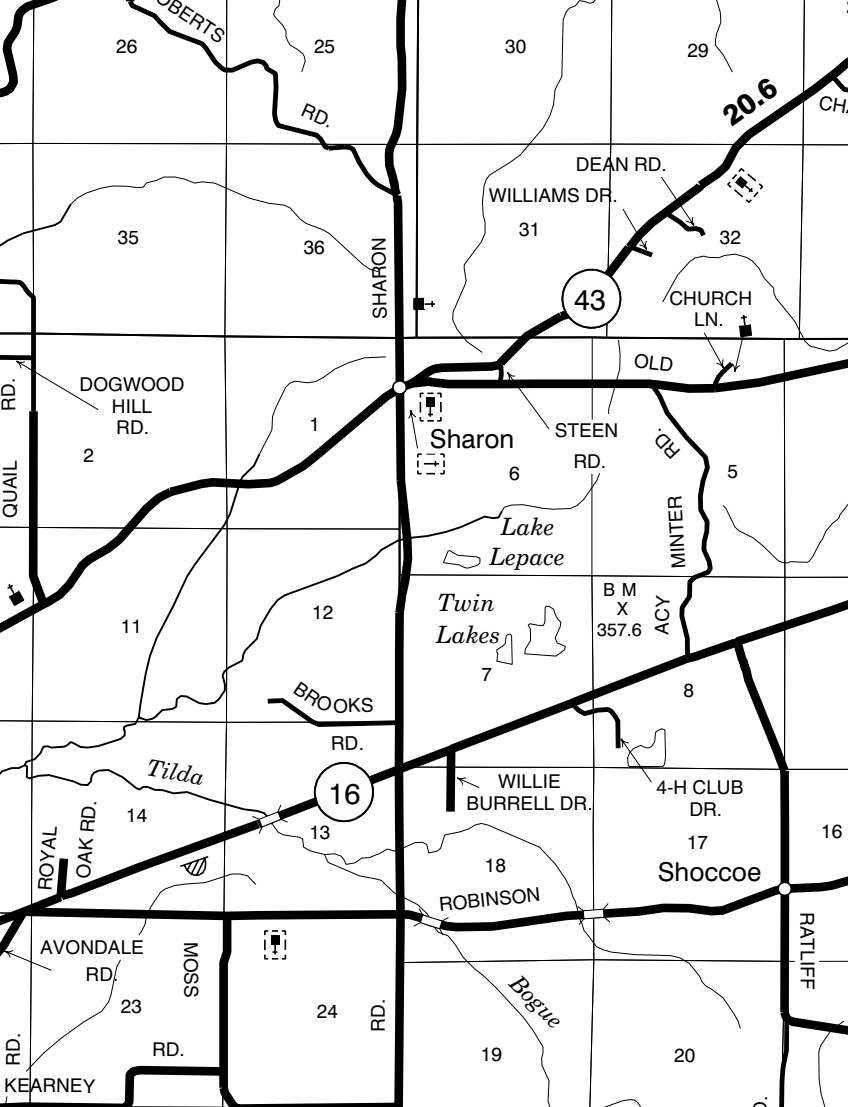
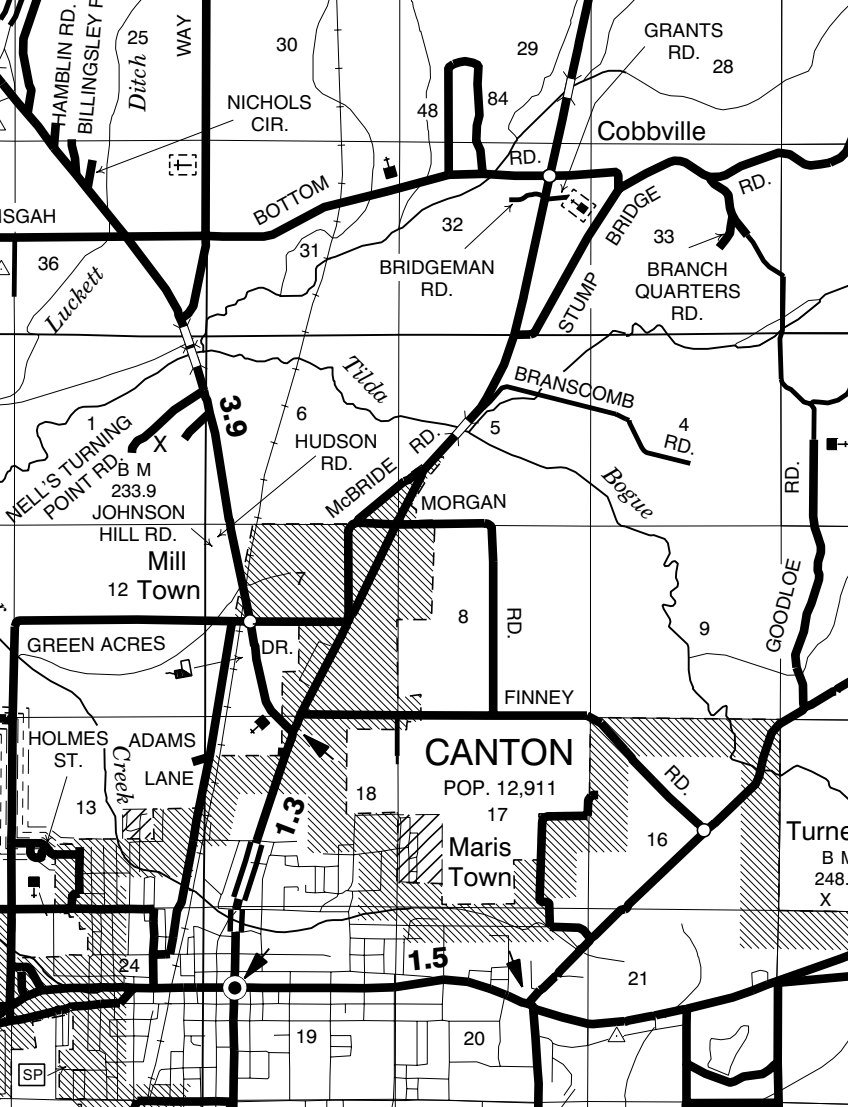
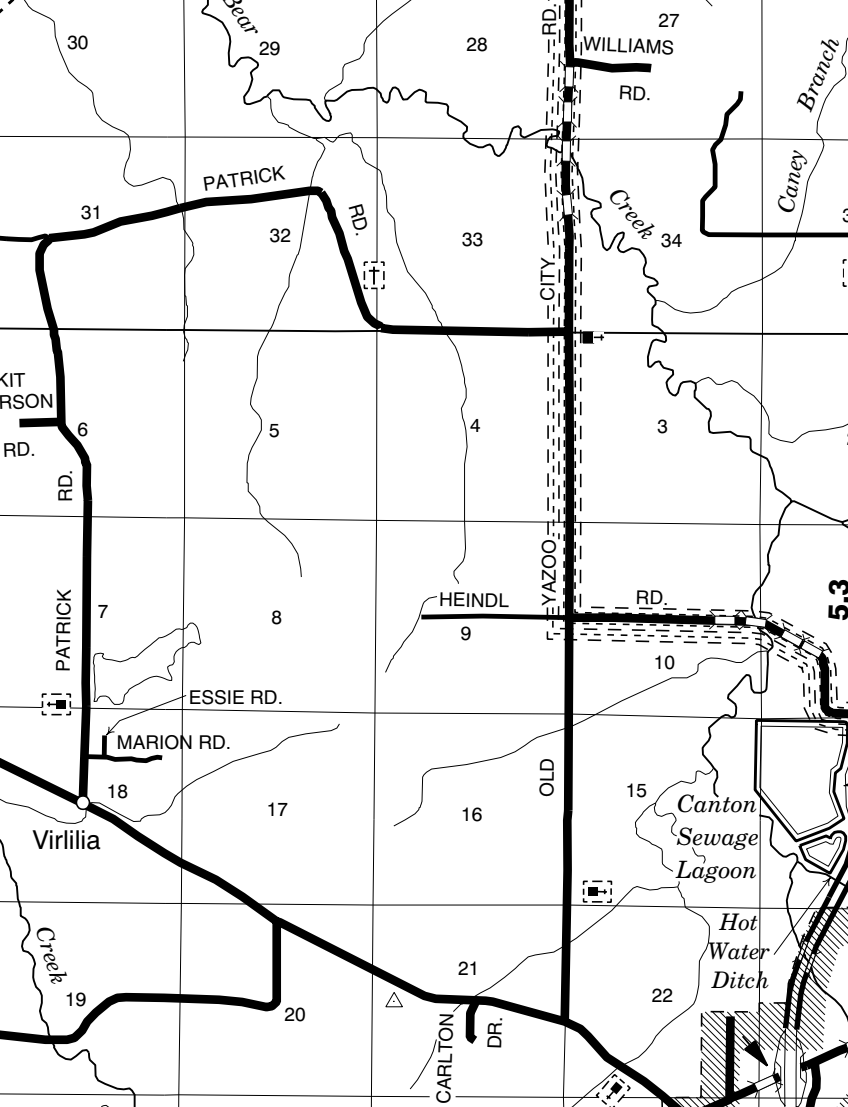
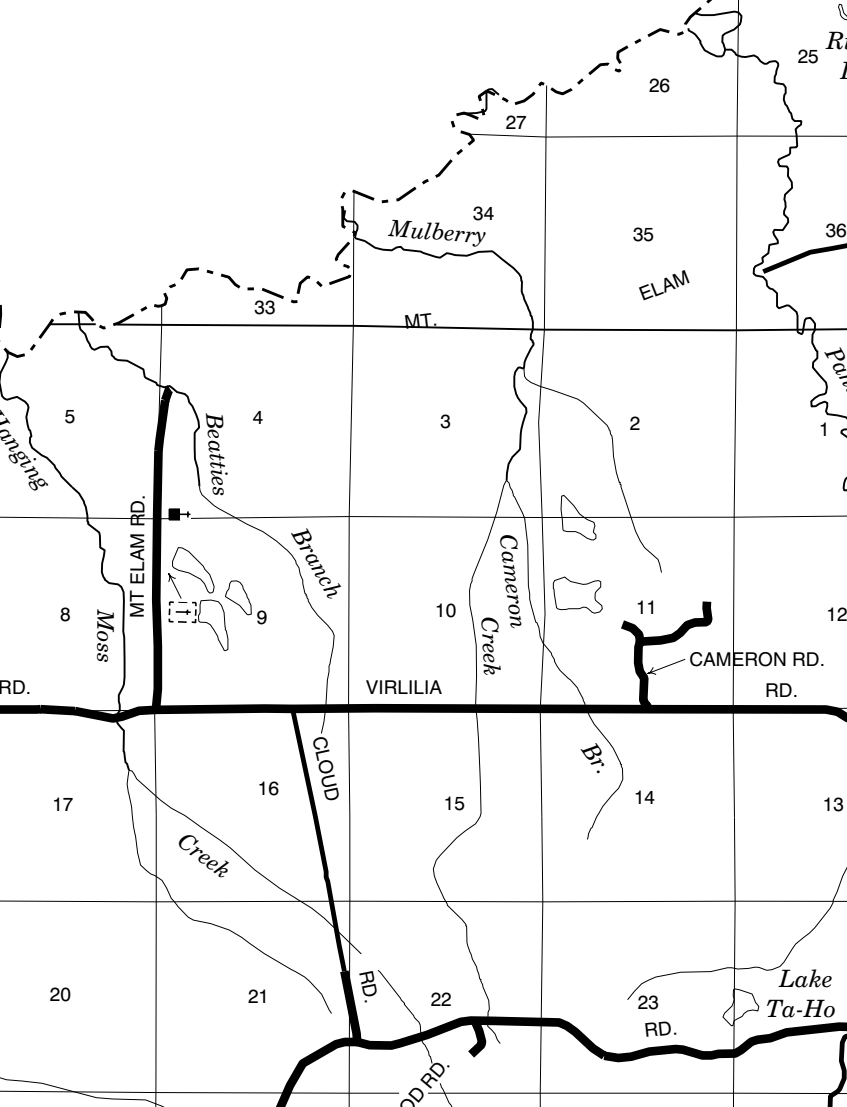
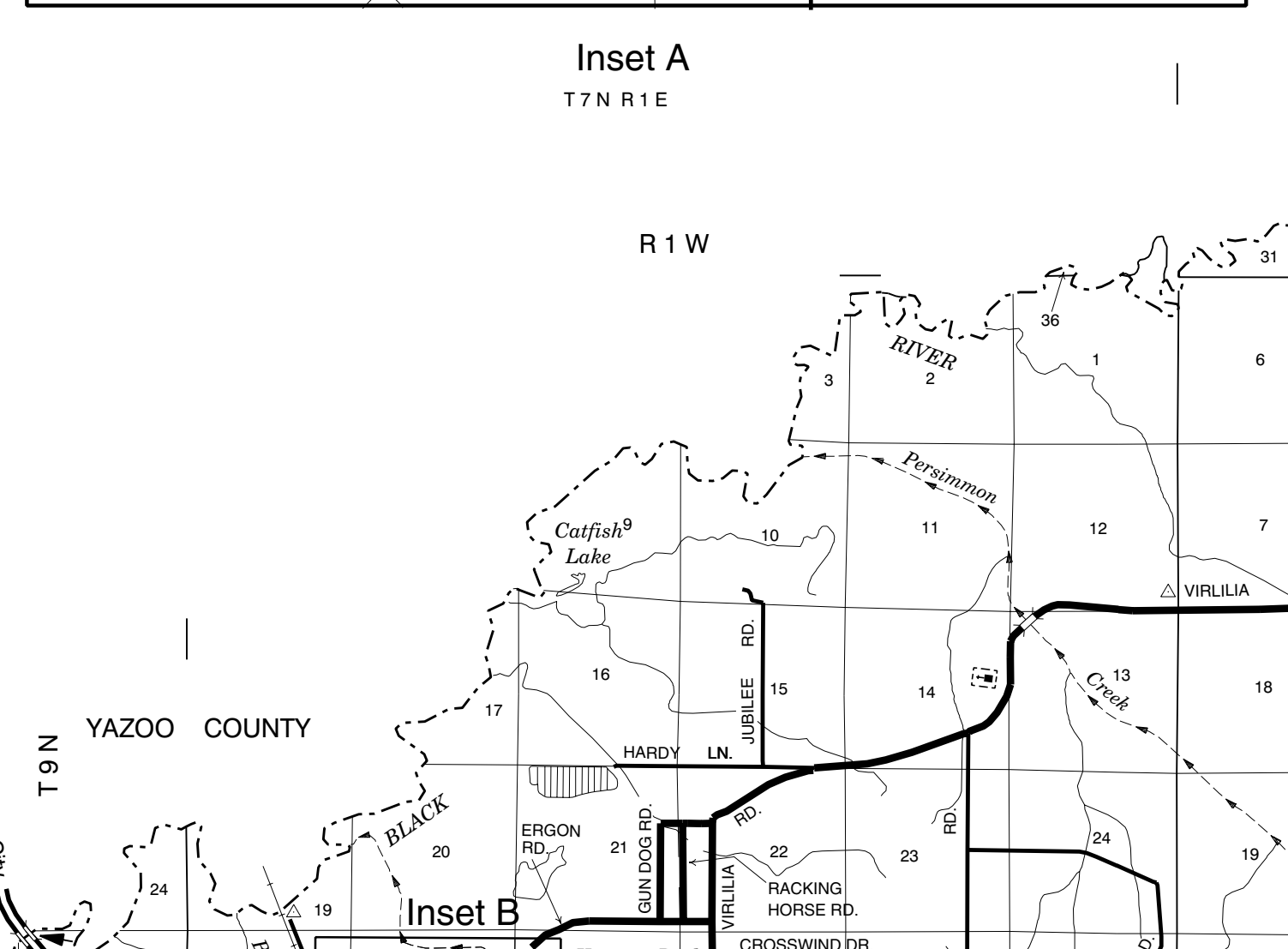
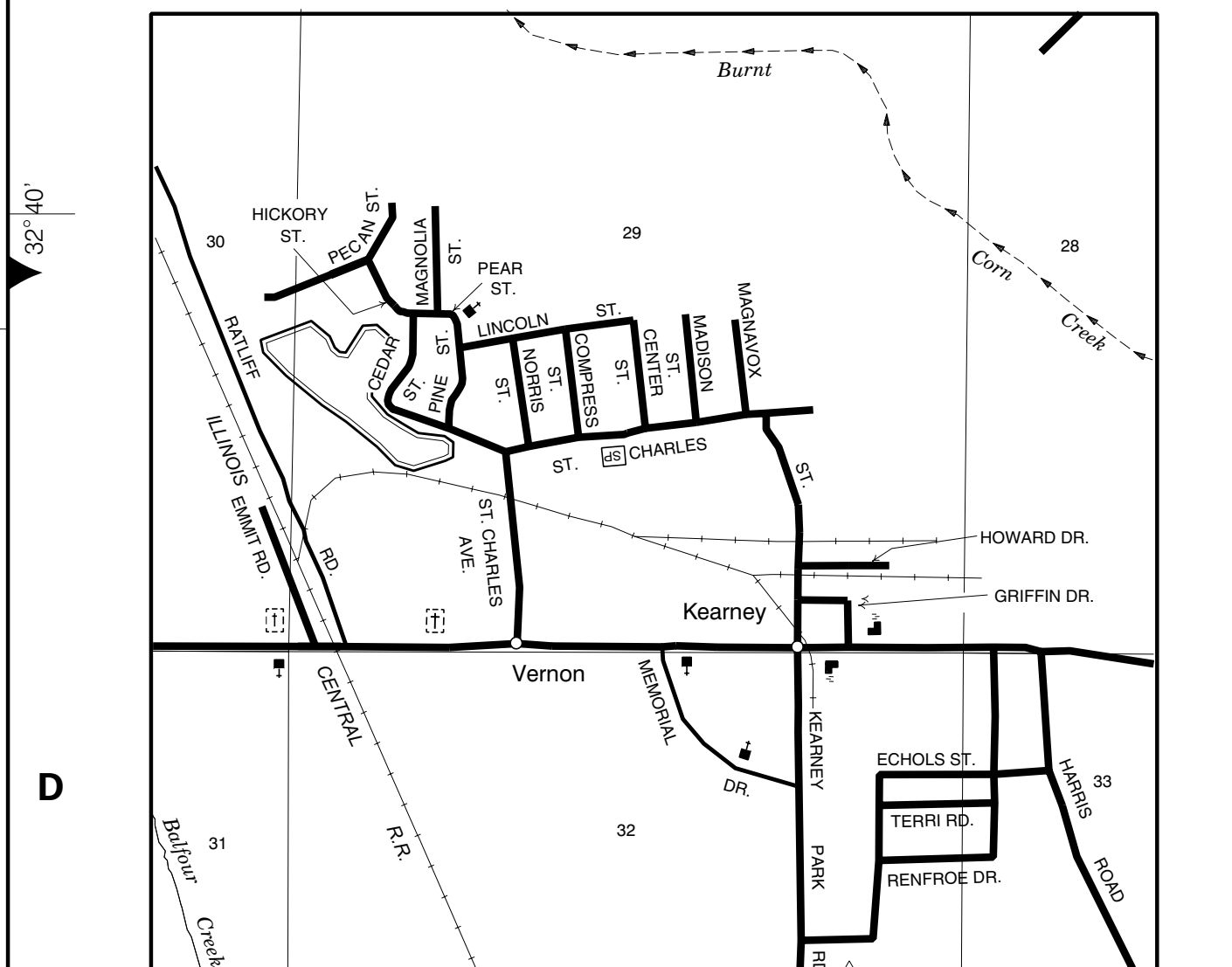
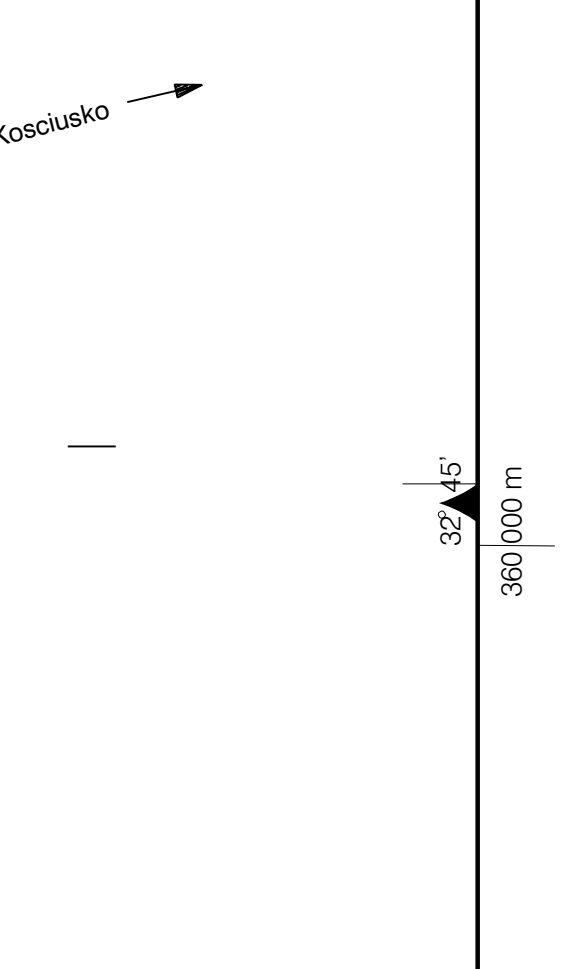
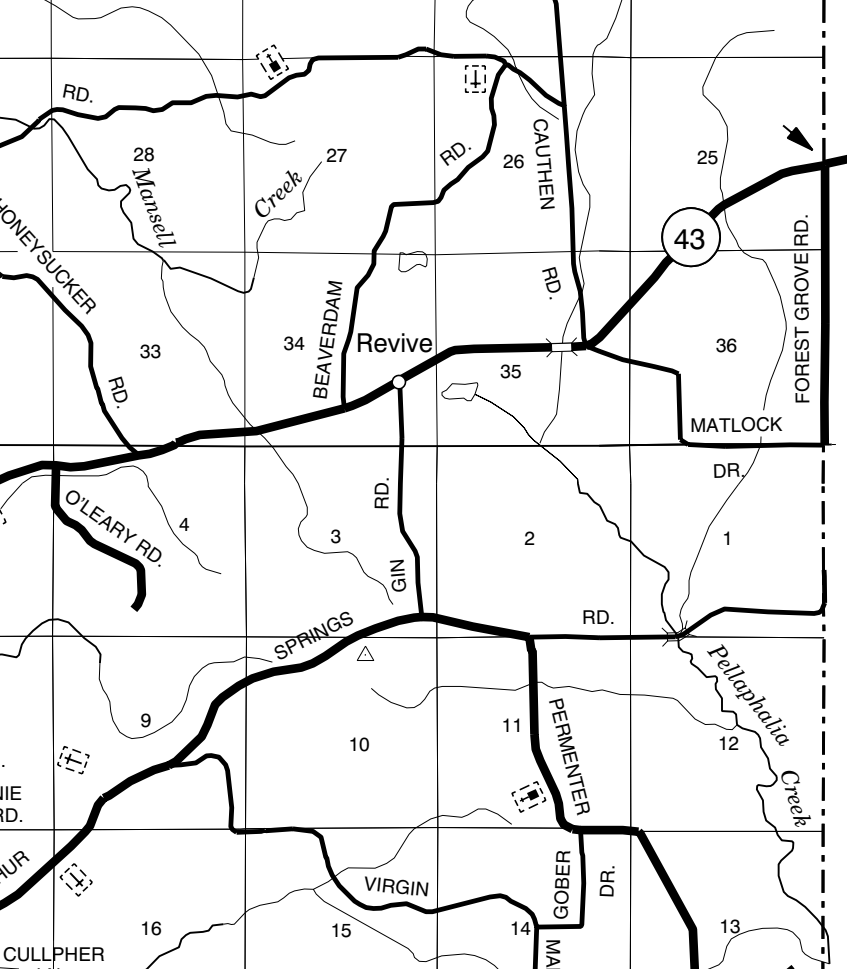
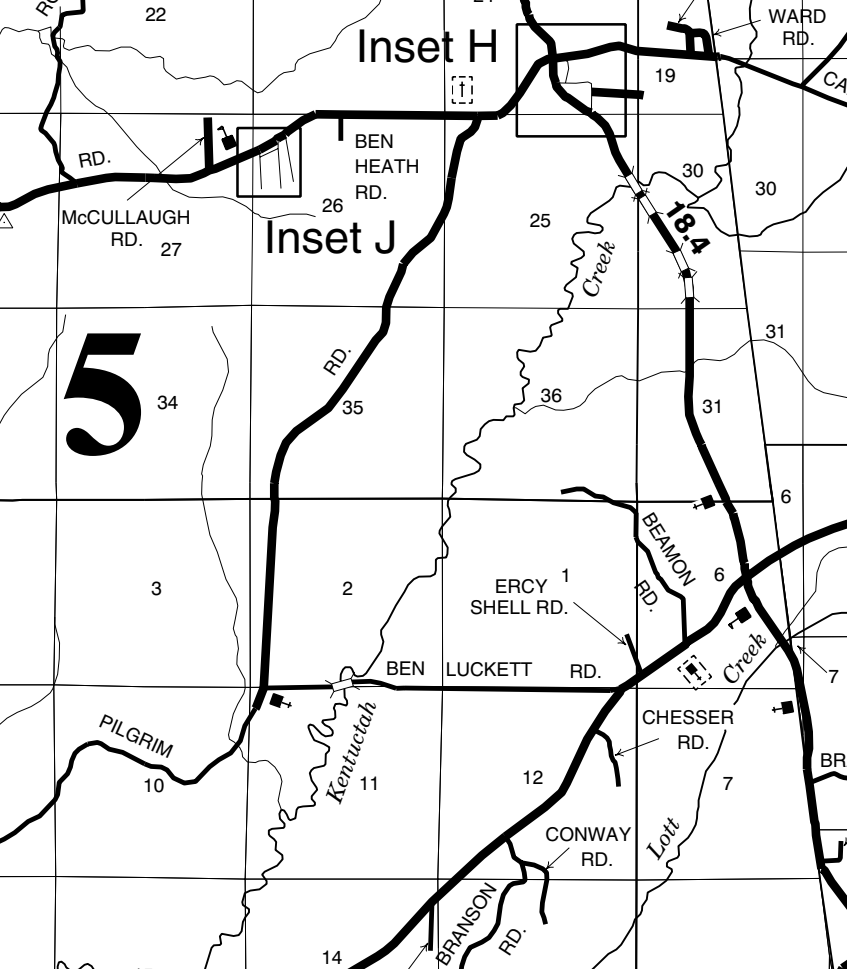
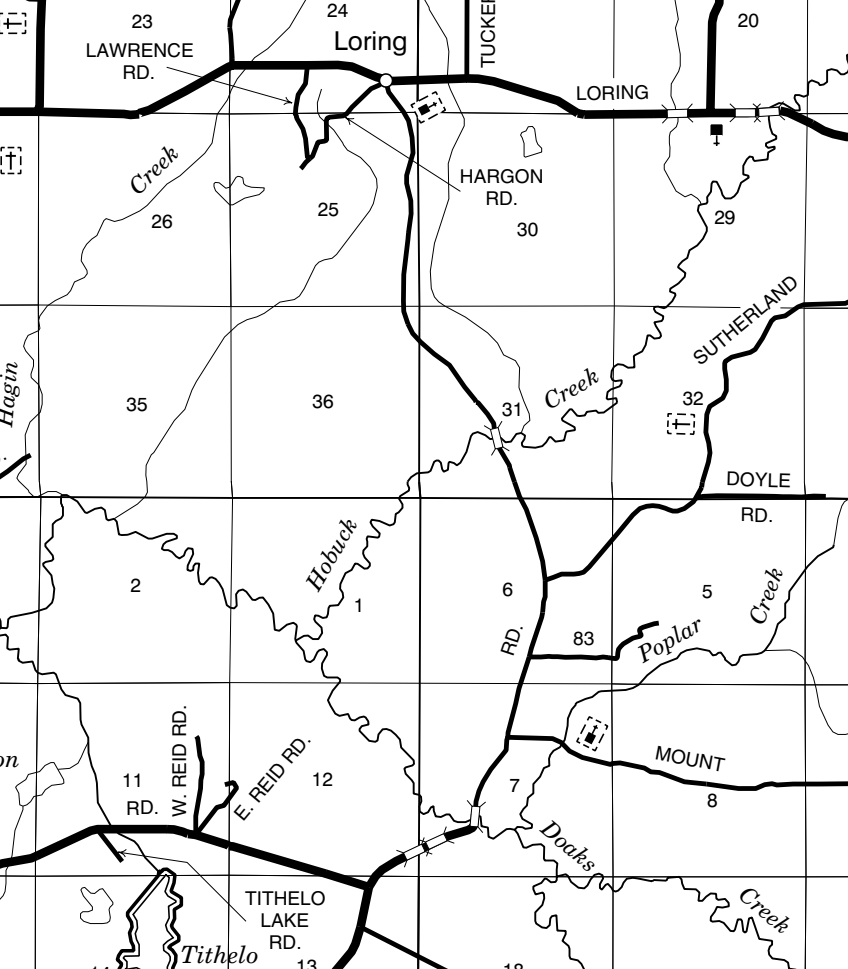
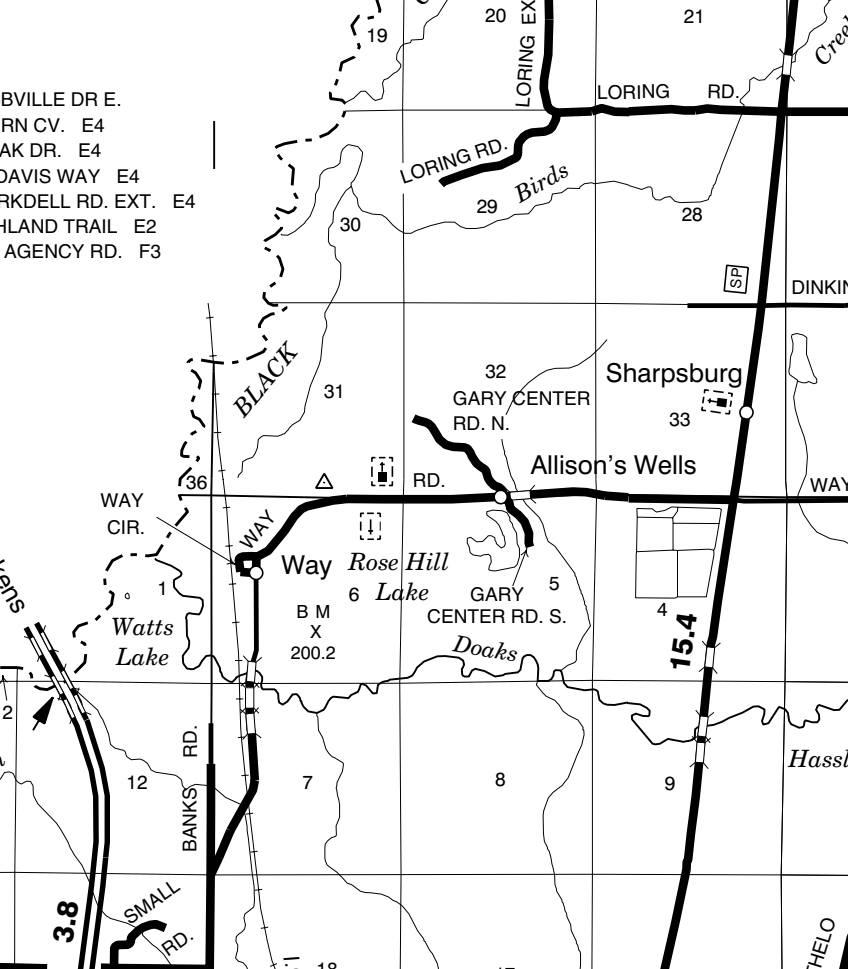
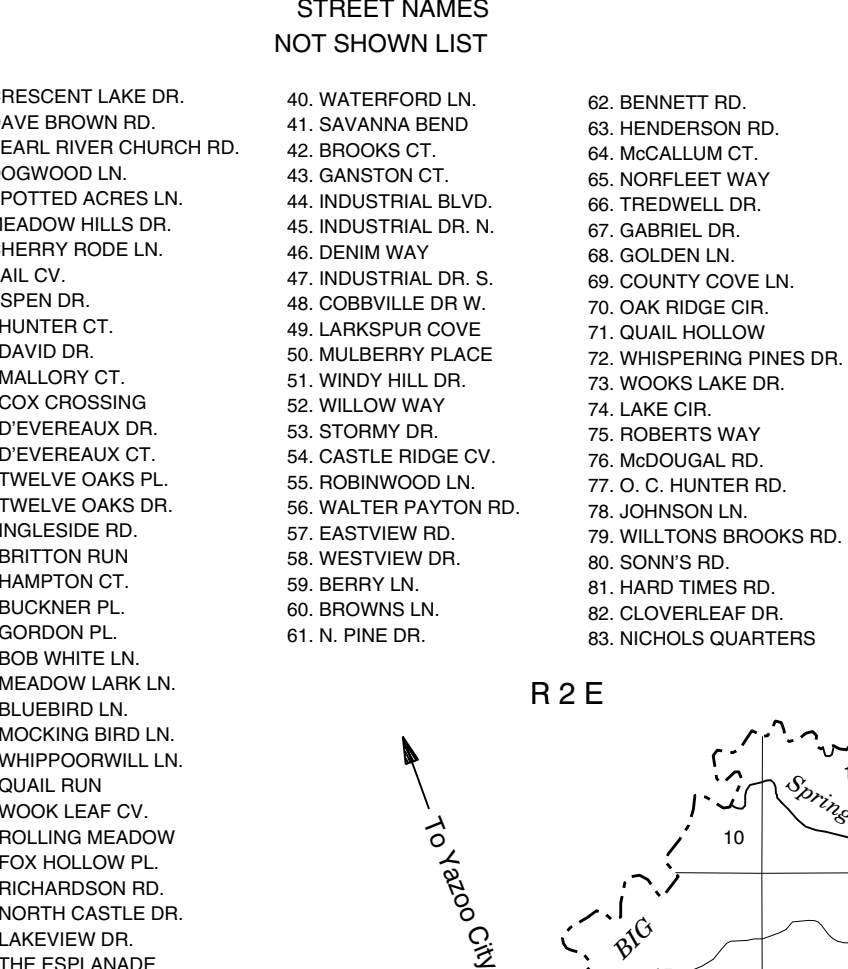
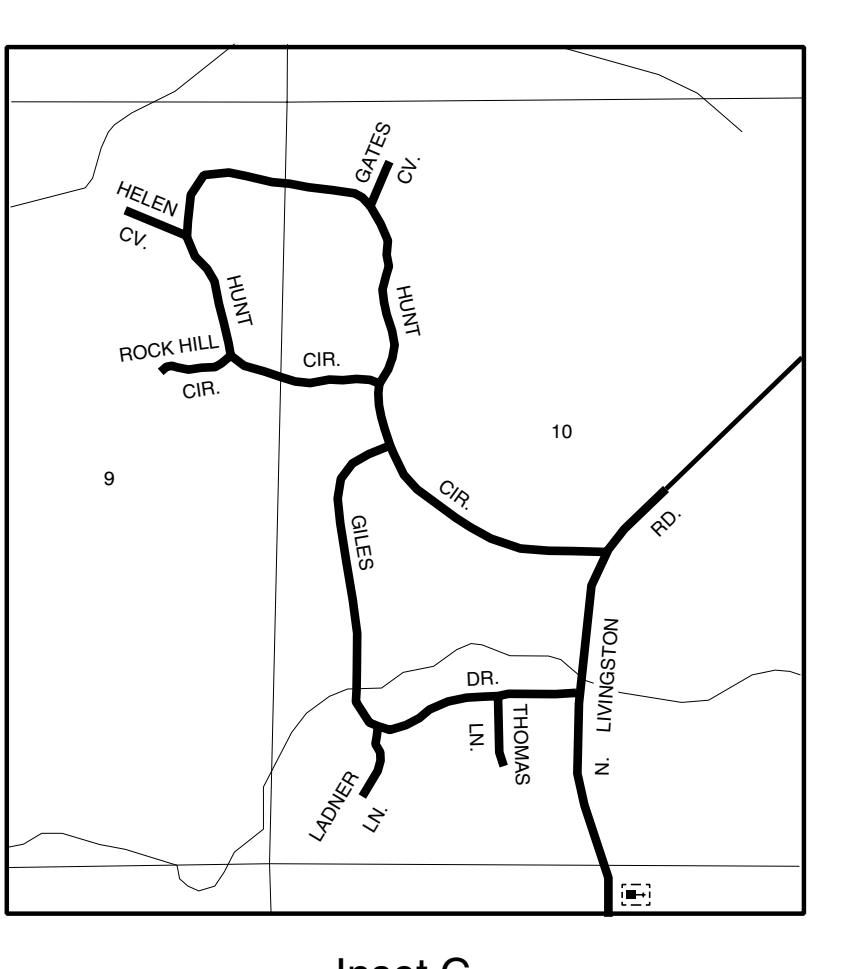
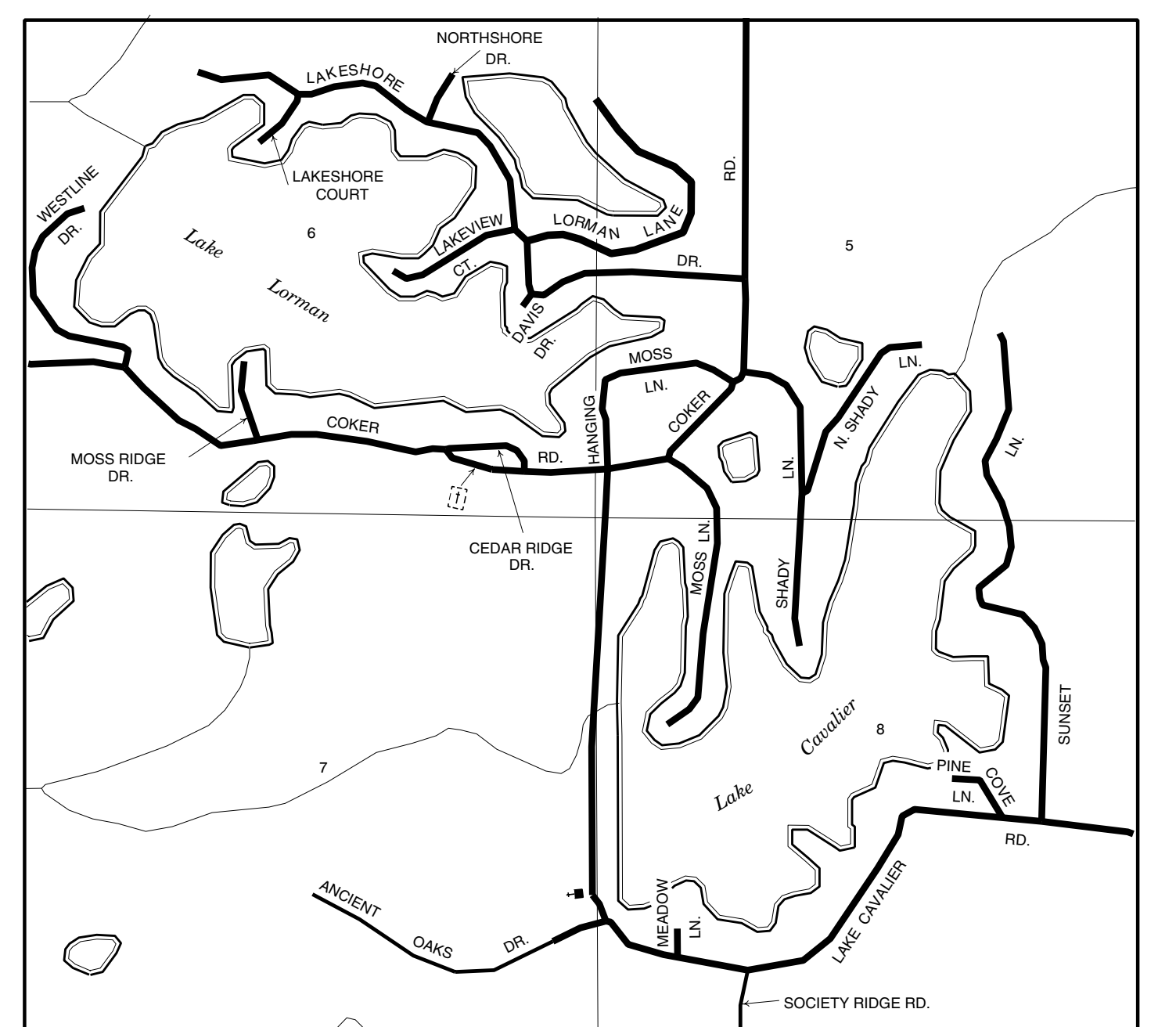

GENERAL HIGHWAY MAP

# MADISON COUNTY

MISSISSIPPI  
© 2004

REVISED: 12/2008

MISSISSIPPI DEPARTMENT OF TRANSPORTATION  
PLANNING DIVISION

IN COOPERATION WITH THE  
U.S. DEPARTMENT OF TRANSPORTATION  
FEDERAL HIGHWAY ADMINISTRATION

TRANSVERSE MERCATOR PROJECTION,  
STATE PLANE COORDINATE SYSTEM 1983

SCALE IN KILOMETERS  
SCALE IN MILES

DATA SOURCES:  
1996 AERIAL PHOTOS  
1997 1:50,000 S.D.G.  
2001 MOOT FIELD INVENTORY  
2000 PEARL RIVER TRAFFIC  
1985 BEAT LINES

THIS MAP WAS COMPUTER GENERATED